

STIGA

Collecting series

MPV 320 W

MPV 520 W

Type *FMC 112*



TOSAERBA CON CONDUCENTE A BORDO SEDUTO
RIDE-ON LAWNMOWER WITH SEATED OPERATOR
TONEUSE À GAZON À CONDUCTEUR ASSIS
AUFSTZMÄHER (RASENMÄHER MIT FAHRERSITZ MIT SITZENDEM BENUTZER)
GRASMAIER MET ZITTENDE BEDIENER
CORTADORA DE PASTO CON CONDUCTOR SENTADO
PÄÄLTÄAJETTAVA RUOHONLEIKKURI
HAVETRAKTOR/HAVETRAKTOR MED FRONTKLIPPER (FM)
ÅKGRÄSKLIPPARE OCH FRÄMRE KLIPPNING (FM)
SEKAČKA SE SEDÍČÍ OBSLUHOV
ISTUVA JUHIGA MURUNITJA
SJEDEĆA KOSILICA TRAVE S OPERATEROM
VEZETŐÜLÉSES FŰNYÍRÓGÉP
BALNINÉ VEJAPJOVÉ SU SÉDINČIU OPERATORIUMI
SĚŽOT VADÁMA ZÁLIENU PĽAUJMAŠÍNA
SITTEGRESSKLIPPER
KOSIARKA Z OPERATEREM JADĄCYM, W POZYCJI SIEDZĄCEJ NA MASZYNE
CORTA-RELVAS PARA OPERADOR SENTADO
TRAKTORSKA KOSILNICA
TRAKTORSKA KOSAČICA (TRAKTORČIC)

MANUALE DI ISTRUZIONI IT
INSTRUCTION MANUAL EN
MANUEL D'UTILISATION FR
GEBRAUCHSANWEISUNG DE
GEBRUIKERSHANDLEIDINGNL NL
USO Y MANTENIMIENTO ES
KÄYTTÖOPAS FI
INSTRUKTIONSMANUAL DA
BRUKSANVISNING OCH UNDERHÅLL SV
INSTRUKTIONSMANUAL CS
KASUTUSJUHEND ET
PRIRUČNIK ZA UPORABU HR
HASZNÁLATI UTASÍTÁS HU
VARTOJIMO INSTRUKCIJA LT
OPERATORA ROKASGRÁMATA LV
BRUKSANVISNING - VEDLIKEHOLD NO
INSTRUKCJE OBSŁUGI PL
MANUAL DE USO PT
RUPRIROČNIK Z NAVODILI SL
PRIRUČNIK SA UPUTSTVIMA SR

MANUALE D'USO E MANUTENZIONE

ISTRUZIONI ORIGINALI

IT

OPERATOR'S MANUAL

Translation of the originals instructions

EN

NOTICE D'UTILISATION

Traduction de la notice originale

FR

BETRIEBSANLEITUNG

Übersetzung der Originalbetriebsanleitung

DE

GEBRUIKSAANWIJZING

Vertaling van de oorspronkelijke gebruiksaanwijzing

NL

MANUAL DEL OPERADOR

Traducción del manual original

ES

KÄYTTÄJÄN KÄSIKIRJA

Alkuperäisten ohjeiden käännös

FI

BETJENINGSVEILEDNING

Oversættelse af den originale brugsanvisning

DA

BRUKSANVISNING

Översättning av original manual

SV

NÁVOD K POUŽITÍ A ÚDRŽBĚ

překlad původního návodu k používání

CS

KASUTUS- JA HOOLDUSJUHEND

Algupärase kasutusjuhendi tõlge

ET

PRIRUČNIK ZA UPORABU I ODRŽAVANJE

Prijevod originalnih uputa

HR

HASZNÁLATI ÉS KARBANTARTÁSI KÉZIKÖNYV

Eredeti használati utasítás fordítása

HU

NAUDOJIMO IR TECHNINĖS PRIEŽIŪROS VADOVAS

Originalių instrukcijų vertimas

LT

LIETOŠANAS UN APKOPES ROKASGRĀMATA

Instrukciju tulkojums no oriģināl valodas

LV

NO

BRUKER- OG VEDLIKEHOLDSHÅNDBOK

Oversettelse av den originale bruksanvisningen

PL

INSTRUKCJA OBSŁUGI I KONSERWACJI

Tłumaczenie instrukcji oryginalnej

PT

MANUAL DE UTILIZAÇÃO E MANUTENÇÃO

Tradução do manual original

SL

PRÍRUČKA NA POUŽITIE A ÚDRŽBU

Preklad originálneho návodu

SR

PRIRUČNIK ZA UPOTREBU I ODRŽAVANJE

Prijevod originalnih uputa

ILLUSTRAZIONI E SCHEMI

ILLUSTRATIONS AND DIAGRAMS

ILLUSTRATIONS ET SCHÉMAS

BILDER UND ZEICHNUNGEN

ILLUSTRATIES EN DIAGRAMMEN

ILUSTRACIONES Y ESQUEMAS

VAROITUSTARRAT JA KUVAT

DIAGRAMTEGNINGER

ILLUSTRATIONER

ILUSTRACE A SCHÉMATA

ILLUSTRATSIOONID JA JOONISED

ILUSTRACIJE I SCHEME

ÁBRÁK ÉS RAJZOK

ILIUSTRACIJOS IR SCHEMOS

ATTĒLI UN SHĒMAS

ILLUSTRASJONER OG SKJEMAER

ILUSTRACJE I SCHEMATY

FIGURAS E ESQUEMAS

ILUSTRÁCIE A SCHÉMY

ILUSTRACIJE I SKICE

DICHIARAZIONE “CE” DI CONFORMITÀ
“EC” DECLARATION OF CONFORMITY
DECLARATION “CE” DE CONFORMITE
“EG”-KONFORMITÄTSEKTLÄRUNG
“EG”-VERKLARING VAN OVEREENSTEMMING
DECLARACION “CE” DE CONFORMIDAD
KONEIDEN EY-VAATIMUSTENMUKAISUUSVAKUUTUS
“EF”-OVERENSSTEMMELSESEKTLÄRINGEN
PRODUKTÖVERENSSTÄMMELSE ENLIGT FABRIKANTEN
„ES“ PROHLÁŠENÍ O SHODĚ
EUROOPA LIIDU VASTAVUSDEKLARATSIOON
IZJAVA O SUKLADNOSTI “CE”
„EK” MEGFELELŐSÉGI NYILATKOZAT
EB ATITIKTIES DEKLARACIJA
“EK” ATBILSTĪBAS DEKLARĀCIJA
EU-SAMSVARSERKLÆRING
DEKLARACJA ZGODNOŚCI „CE”
DECLARAÇÃO “CE” DE CONFORMIDADE
VYHLÁŠENIE „CE“ O ZHODE
CE IZJAVA O USKLAĐENOSTI

Il fabbricante, the Manufacturer, le fabricant, der Hersteller,
de Fabrikant, el fabricante, valmistaja, Producenten, Tillverkaren, Výrobce, Tootja, Proizvođač,
A gyártó, Gamintojas, Ražotājs, Produzent, Producent, O fabricante, Výrobca, Proizvođač:

OFFICINE BIEFFEBI S.p.A.

Via dell'Artigianato, 7 - GONZAGA (MN) - ITALY

DICHIARA CHE LA MACCHINA

DESIGNAZIONE DELLA MACCHINA: **RASAEERBA CON CONDUCENTE SEDUTO E TAGLIO FRONTALE**

CERTIFIES THAT THE MACHINE

DESIGNATION OF THE MACHINE: **LAWNMOWER WITH SITTING DRIVER AND FRONTAL CUTTING**

CERTIFIE QUE LA MACHINE

DÉSIGNATION DE LA MACHINE: **TONDEUSE AVEC CHAUFFEUR ASSIS ET COUPER AVANT**

ERKLÄRT DASS DIE MASCHINE

BEZEICHNUNG DER MASCHINE: **RASENMÄHER MIT DRIVER SITZEN UND VORDERE SCHNEID**

VERKLAART DAT DE MACHINE

AANWIJZING VAN DE MACHINE: **GRASMAAIMACHINE MET AANZITTEN DRIVER EN FRONTAL SNIJDEN**

DECLARA QUE LA MÁQUINA

DESIGNACIÓN DE LA MÁQUINA: **CORTACÉSPED CON CONDUCTOR SENTADO Y CORTE EN FRENTE**

ILMOITTA, ETTÄ MONITOIMIKONE

TYYPIMERKINTÄ: **RUOHONLEIKKURI ISTUU OHJAIN JA FRONTAL LEIKKAUS**

ERKLÆRER AT DENNE MASKINEN

UDPEGNING AF MASKINEN: **PLÆNEKLIPPER MED DRIVER MØDET OG FRONTAL CUTTING**

INTYGAR ATT MASKINEN

MASKINTYP: **GRÄSKLIPPARE MED FÖRAREN SITTANDE OCH FRONTALA KAPNING**

PROHLAŠUJE, ŽE STROJ
OZNAČENÍ STROJE: **ZAHRADNÍ TRAKTOR S PŘEDNÍM SEČENÍM**
DEKLAREERIB, ET MASIN

MASINA KIRJELDUS **EESASUVA NIIDUSEADMEGA RAIDER**

IZJAVLJUJE DA JE STROJ

NAMJENA STROJA: **SJEDEĆA KOSILICA TRAVE - RIDER S PREDNJOM KOSOM**
KIJELENTI, HOGY A GÉP

RENDELTETÉSE: **ELŐL VÁGÓ, VEZETŐÜLÉSES FŰNYÍRÓ TRAKTOR**
PATVIRTINA, KAD MAŠINA

MAŠINOS PASKIRTIS: **VEJOS PJOVIMO TRAKTORIUKAS SU PRIEKYJE SUMONTUOTU PJOVIMO AGREGATU**
APLIECINA, KA MAŠINA

MAŠINAS NOSAUKUMS: **ZĀLIENU PĻAUJMAŠĪNA AR VADĪTĀJA SĒDEKLI UN PRIEKŠPUSĒ**
UZSTĀDĪTU GRIEŠANAS MEHĀNISMU
ERKLÆRER AT MASKINEN

BETGNELSE PÅ MASKINEN. **GRESSKLIPPER MED FØRERSETE OG FRONTKLIPPING**
DEKLARUJE, ŽE MASZYNA

OZNACZENIE MASZYNY: **KOSIARKA SAMOJEZDNA Z MIEJSCEM DLA OPERATORA Z PRZEDNIM**
AGREGATEM TNACYM
DECLARA QUE A MÁQUINA

DESIGNAÇÃO DA MÁQUINA: **CORTA RELVA FRONTAL COM CONDUTOR SENTADO**
PREHLASUJE, ŽE STROJ

OZNAČENIE STROJA **KOSAČKA SO SEDIACOU OBSLUHOU A ČELNÝM REZOM**
IZJAVLJUJE DA JE MAŠINA

OZNAKA MAŠINE: **KOSILICA SA SEDIŠTEM I SEČIVOM SA PREDNJE STRANE**

Marca, Brand, Marque, Brand, Merk, Marca, Merkki,
Mærke, Fabrikat, Značka, Tootemark, Marka, Prekės ženklas,
Preču zīme, Merke, Marka, Marca, Značka, Marka: **STIGA**

Modello, Model, Modèle, Typ, Model, Modelo, Malli, Type,
Modell, Model, Mudel, Model, Model, Modell, Modelis,
Modelis, Modell, Model, Modelo, Model, Model:

Número di serie, Serial number, Numero de série, Seriennummer,
Seriennummer, Numero de serie, Valmistenumero, Løbenummer,
Seriennummer, Sériové číslo, Seerianumber, Serijski broj, Sorozatszám,
Serijos numeris, Sērijas numurs, Serienummer, Numer seryjny,
Número de série, Sériové číslo, Broj serije:

Livello di potenza sonora misurato, Sound power level measured,
Niveau de puissance sonore mesuré, Gemessener Schallleistungspegel,
Gemeten niveau van geluidsvermogen, Nivel de potencia sonora medido,
Mitattu äänitehotaso, Målt lydtekniveau, Uppmått ljudteknivå,
Nāmerēnā ūroven ākustickēho vȳkonu, Mōdētud helivōimsuse tase,
Izmjerenā razina zvūčne snage, Mért zajtjeljesitmény szint,
Išmatuotas garso galios lygis, Izmēritais skanas intensitātes līmenis,
Mālt lydteknivā, Zmierzōny poziom mocy ākustycznej,
Nivel medido de potencia sonora, Izmerjen nivo zvōčne moči,
Izmereni nivo zvūčne snage: 100 dB(A)

Livello di potenza sonora garantito, Sound power level guaranteed,
 Niveau de puissance sonore garanti, Garantierter Schalleistungspegel,
 Gegarandeerd niveau van geluidsvermogen, Nivel de potencia sonora garantizado,
 Taattu äänitehotaso, Garanteret lydeffektniveau, Garanterad ljudeffektivnivå,
 Zaručena uroveň akustického výkonu, Garanteeritud helivõimsuse tase,
 Zajamčena razina zvučne snage, Garantált zajteljesítmény szint,
 Užtikrinamas garso galios lygis, Garantētais skaņas intensitātes līmenis,
 Garantert lydeffektivnivå, Gwarantowany poziom mocy akustycznej,
 Nivel garantido de potência sonora, Zagotovljen nivo zvočne moči,
 Garantovani nivo zvučne snage: 100 dB(A)

Ampiezza di taglio, Range of cut, Largeur de coupe, Schnittbreite, Snijbreedte,
 Amplitud de corte, Leikkuuleveys, Klippebredde, Klippbredd, Sirka rezani, Lõikelaius,
 Sirina rezanja, Vágási szélesség, Pjovimo plotis, Pļaušanas platums, Klippebredde,
 Szerokość cięcia, Amplitude de corte, Obseg košnje, Sirina košenja: 112 cm

E' CONFORME ALLE DISPOSIZIONI PERTINENTI DELLE SEGUENTI DIRETTIVE EUROPEE:

IT

- Direttiva “Macchine” 2006/42/CE (e successive modifiche ed integrazioni) e alle disposizioni nazionali di attuazione (*).
 (*) Procedura di valutazione della conformità: Allegato VIII
 - Direttiva 2014/30/EU: requisiti essenziali di sicurezza e di salute relativi alla compatibilità elettromagnetica delle apparecchiature (e successive modifiche ed integrazioni).
 - OND: 2000/14/EC, ANNEX VI - 2005/88/EC;
 Ente certificatore: N°0197-TÜV Rheinland LGA Products GmbH Tillystrasse 2, 90431 Nürnberg – Germany;
- Riferimento alle norme armonizzate:
- EN ISO 5395-1:2013;
 - EN ISO 5395-3:2013;
 - EN 55012:2007/A1:2009
 - EN ISO 14982:2009
- Inoltre, si precisa che, il sottoscritto Ferrari Claudio in qualità di presidente della ditta “OFFICINE BIEFFEBI S.p.A.” con sede in via dell’ Artigianato 7, 46023, Gonzaga (Mn) - ITALY è il responsabile a costituire e a custodire il fascicolo tecnico.

COMPLIES WITH THE FOLLOWING PERTINENT EUROPEAN DIRECTIVES:

EN

- Machine directive 2006/42/CE (and following amendments and integrations) and national execution measures(*).
 - (*) Compliance evaluation procedure: enclosure VIII
 - Machine directive 2014/30/EU: Essential safety and health requirements of electromagnetic compatibility of equipment (and further amendments and integrations).
 - OND: 2000/14/EC, ANNEX VI - 2005/88/EC;
 Certifying body: N°0197-TÜV Rheinland LGA Products GmbH Tillystrasse 2, 90431 Nürnberg – Germany;
- Reference to harmonized standards:
- EN ISO 5395-1:2013;
 - EN ISO 5395-3:2013;
 - EN 55012:2007/A1:2009
 - EN ISO 14982:2009
- Furthermore it is stipulated that Claudio Ferrari in quality of President and depositary of the technical dossier of the company OFFICINE BIEFFEBI S.p.A. via dell’ Artigianato 7, 46023, Gonzaga (Mn) - ITALY is responsible for the production and the follow up of the technical manual.

RÉPOND AUX EXIGENCES PRÉVUES PAR LES DIRECTIVES EUROPÉENNES:

FR

- Directive sur les machines n°2006/42/CE (y compris ses amendements et rajouts) et ses mesures d’exécution nationale. (*)
 - (*) Procédure d’évaluation de la mise en conformité : annexe VIII
 - Directive sur les machines n°2014/30/EU: Exigences essentielles en matière de protection et de santé sur la compatibilité électromagnétique (CEM) des équipements (ainsi que tout autre amendement et rajout).
 - OND: 2000/14/EC, ANNEX VI - 2005/88/EC;
 Organisme de certification : N°0197-TÜV Rheinland LGA Products GmbH Tillystrasse 2, 90431 Nürnberg – Germany;
- Référence aux normes harmonisées:
- EN ISO 5395-1:2013;
 - EN ISO 5395-3:2013;
 - EN 55012:2007/A1:2009
 - EN ISO 14982:2009
- En outre, il est stipulé que Claudio Ferrari, en qualité de Président et dépositaire du dossier technique de la société OFFICINE BIEFFEBI S.p.A. via dell’ Artigianato 7, 46023, Gonzaga (Mn) - ITALIE est responsable de la rédaction et du suivi du manuel technique.

DEN FOLGENDEN EUROPÄISCHEN RICHTLINIEN ENTSPRICHT:

- Maschinenrichtlinie 2006/42/EG (in der geltenden Fassung) und den nationalen Durchführungsbestimmungen (*).
- (*) Verfahren für die Bewertung der Konformität: Anlage VIII
- Richtlinie 2014/30/EU: Grundlegende Sicherheits- und Gesundheitsanforderungen hinsichtlich der elektromagnetischen Verträglichkeit von Geräten (in der geltenden Fassung).
- OND: 2000/14/EC, ANNEX VI - 2005/88/EC;
- Zertifizierungsstelle: N°0197-TÜV Rheinland LGA Products GmbH Tillystrasse 2, 90431 Nürnberg – Germany;

Bezugnahme auf harmonisierte Normen:

- EN ISO 5395-1:2013;
- EN ISO 5395-3:2013;
- EN 55012:2007/A1:2009
- EN ISO 14982:2009
- Des weiteren wird darauf hingewiesen, dass der Unterzeichnete, Ferrari Claudio, in seinem Amt als Präsident der Firma „OFFICINE BIEFFEBI S.p.A.“ mit Sitz in Via dell'Artigianato 7, 46023, Gonzaga (Mn) - ITALIEN für die Verfassung und Aufbewahrung der technischen Unterlagen verantwortlich ist.

VOLDOET AAN DE VOLGENDE EUROPESE RICHTLIJNEN:

- Machine richtlijn 2006/42/CE (en de volgende wijzigingen en integraties) en de nationale uitvoeringsmaatregelen.(*)
- (*) Met inachtneming van evaluatieprocedure: bijlage VIII
- Machine richtlijn 2014/30/EU: Essentiële veiligheids- en gezondheidseisen van de elektromagnetische compatibiliteit van de uitrusting (en verdere wijzigingen en integraties).
- OND: 2000/14/EC, ANNEX VI - 2005/88/EC;
- Certificatie-instituut: N°0197-TÜV Rheinland LGA Products GmbH Tillystrasse 2, 90431 Nürnberg – Germany;

Verwijzing naar de geharmoniseerde normen:

- EN ISO 5395-1:2013;
- EN ISO 5395-3:2013;
- EN 55012:2007/A1:2009
- EN ISO 14982:2009
- Voorts is bepaald dat Claudio Ferrari in de kwaliteit van de president en de bewaarder van het technisch dossier van Officine BIEFFEBI SpA Via dell 'Artigianato 7, 46023, Gonzaga (Mn) - Italië verantwoordelijk is voor de productie en het naleven van de technische handleiding.

ES CONFORME A LAS DISPOSICIONES PERTINENTES DE LAS SIGUIENTES DIRECTIVAS EUROPEAS:

- Directiva “Máquinas” 2006/42/CE (y posteriores modificaciones e integraciones) y a las disposiciones nacionales de aplicación (*).
- (*) Procedimiento de valoración de la conformidad: Anexo VIII
- Directiva 2014/30/EU: requisitos esenciales de seguridad y de salud relativos a la compatibilidad electromagnética de los equipos (y posteriores modificaciones e integraciones).
- OND: 2000/14/EC, ANNEX VI - 2005/88/EC;
- Ente certificador: N°0197-TÜV Rheinland LGA Products GmbH Tillystrasse 2, 90431 Nürnberg – Germany;

Referencia a las normas armonizadas:

- EN ISO 5395-1:2013;
- EN ISO 5395-3:2013;
- EN 55012:2007/A1:2009
- EN ISO 14982:2009
- Además, se precisa que el abajo firmante Ferrari Claudio, en calidad de presidente de la sociedad “OFFICINE BIEFFEBI S.p.A.” con sede en via dell'Artigianato 7, 46023, Gonzaga (MN) - ITALIA, es el responsable de constituir y custodiar el expediente técnico.

ON YHDENMUKAINEN SEURAAVIEN EUROOPPALAISTEN DIREKTIIVIEN KANSSA:

- Konedirektiivi 2006/42/EY (ja myöhemmät muutokset ja lisäykset) ja kansalliset säädökset (*).
- (*) Yhdenmuokaisuuden arviointiproseduuri: Liite VIII
- Direktiivi 2014/30/EU: laitteiden elektromagneettiseen yhteensopivuuteen liittyvät turvallisuutta ja terveyttä koskevat vaatimukset (ja myöhemmät muutokset ja lisäykset).
- OND: 2000/14/EC, ANNEX VI - 2005/88/EC;
- Sertifiointiyritys: N°0197-TÜV Rheinland LGA Products GmbH Tillystrasse 2, 90431 Nürnberg – Germany;

Viite Yhdenmukaistettuja standardeja:

- EN ISO 5395-1:2013;
- EN ISO 5395-3:2013;
- EN 55012:2007/A1:2009
- EN ISO 14982:2009
- Lisäksi ilmoittaa, että allekirjoittaja Ferrari Claudio yrityksen “OFFICINE BIEFFEBI S.p.A.” osoitteessa via dell' Artigianato 7, 46023, Gonzaga (MN) - ITALY johtaja, on vastuussa teknisen asiakirja-aineiston kehittämisestä ja säilyttämisestä.

ER I OVERENSSTEMMELSE MED FØLGENDE RELEVANTE EUROPÆISKE DIREKTIVER:

- Maskindirektiv 2006/42/CE (og yderligere tillæg) og nationale effektuerende mål. (*)
- (*) Evalueringsprocedure: bilag VIII
- Maskindirektiv 2014/30/EU: Afgørende sikkerheds- og sundhedskrav for materiellets elektromagnetiske kompatibilitet (og yderligere tillæg)
- OND: 2000/14/EC, ANNEX VI - 2005/88/EC;

Certificeringsorgan: N°0197-TÜV Rheinland LGA Products GmbH Tillystrasse 2, 90431 Nürnberg – Germany;

Henvielse til harmoniserede standarder:

- EN ISO 5395-1:2013;
- EN ISO 5395-3:2013;
- EN 55012:2007/A1:2009
- EN ISO 14982:2009
- Endvidere er der stillet som betingelse at Claudio Ferrari i egenskab af direktør og depositar for den tekniske afdeling i firmaet OFFICINE BIEFFEBI S.p.A. via dell' Artigianato 7, 46023, Gonzaga (Mn) Italy er ansvarlig for og opfølgningen af den tekniske vejledning.

ÖVERENSTÄMMER MED FÖLJANDE RELEVANTA EUROPEISKA DIREKTIV:

- Maskindirektiv 2006/42/CE (och ytterligare tillägg) och nationellt effektuerade mål. (*)
- (*) Evalueringsprocedur: bilaga VIII
- Maskindirektiv 2014/30/EU: Avgörande säkerhets- och hälsokrav för utrustningens elektromagnetiska kompatibilitet (och ytterligare tillägg)
- OND: 2000/14/EC, ANNEX VI - 2005/88/EC;

Anmälat organ: N°0197-TÜV Rheinland LGA Products GmbH Tillystrasse 2, 90431 Nürnberg – Germany;

Hänvisning till harmoniserade standarder:

- EN ISO 5395-1:2013;
- EN ISO 5395-3:2013;
- EN 55012:2007/A1:2009
- EN ISO 14982:2009
- Vidare är det så att Claudio Ferrari i egenskap av direktör för den tekniska avdelningen inom OFFICINE BIEFFEBI S.p.A. via dell' Artigianato 7, 46023, Gonzaga (Mn) Italien är ansvarig för produktion och uppföljning av tekniska manualer.

SPLŇUJE POŽADAVKY NÁSLEDUJÍCÍCH SMĚRNIC EU:

- Směrnice „O strojních zařízeních“ 2006/42/ES (ve znění pozdějších změn a doplňků) a národních prováděcích předpisů (*).
- (*) Postup posuzování shody: Příloha VIII
- Směrnice 2014/30/ES: základní požadavky týkající se bezpečnosti a ochrany zdraví a vztahující se k elektromagnetické kompatibilitě zařízení (ve znění pozdějších změn a doplňků).
- OND: 2000/14/ES, PŘÍLOHA VI - 2005/88/ES;

Certifikační orgán: N°0197-TÜV Rheinland LGA Products GmbH Tillystrasse 2, 90431 Nürnberg – Germany;

Odkaz na harmonizované normy:

- EN ISO 5395-1:2013;
- EN ISO 5395-3:2013;
- EN 55012:2007/A1:2009
- EN ISO 14982:2009
- Kromě toho dodáváme, že níže podepsaný Claudio Ferrari jako prezident firmy „OFFICINE BIEFFEBI S.p.A.“, se sídlem via dell' Artigianato 7, 46023, Gonzaga (Mn) - ITÁLIE, je odpovědný za zpracování a uchování technické dokumentace.

VASTAB JÄRGMISTE EUROOPA LIIDU DIREKTIIVIDE ASJAKOHASTELE NÕUETELE:

- masinate direktiiv 2006/42/EÜ (koos hilisemate muudatuste ja täiendustega) ning selle riigisisesed rakendussätted (*).
- (*) Vastavushindamise menetlus: VIII lisa
- direktiiv 2014/30/EL: seadmete elektromagnetilise ühilduvusega seotud olulised turvalisus- ja ohutusnõuded (ning nende hii-semad muudatused ja täiendused).
- välitingimustes kasutatavate seadmete mõra: 2000/14/EÜ, VI LISA – 2005/88/EÜ;

Kinnitav asutus: N°0197-TÜV Rheinland LGA Products GmbH Tillystrasse 2, 90431 Nürnberg – Germany;

harmoneeritud standardid:

- EN ISO 5395-1:2013;
- EN ISO 5395-3:2013;
- EN 55012:2007/A1:2009;
- EN ISO 14982:2009;
- tehnilise dokumentatsiooni koostamise ja hoidmise eest vastutab allkirjutanu Ferrari Claudio, äriühingu OFFICINE BIEFFEBI S.p.A. (aadressiga via dell' Artigianato 7, 46023, Gonzaga (Mn) - ITAALIA) nõukogu esimees.

U SKLADU S ODREDBAMA SLJEDEĆIH EUROPSKIH DIREKTIVA:

HR

- Direktive “o strojevima” 2006/42/EZ (i njezinih izmjena i dopuna) te nacionalnih provedbenih odredbi (*).
- (*) Postupak ocjene sukladnosti: Prilog VIII.
- Direktive 2014/30/EU: bitni zahtjevi u vezi sigurnosti i zdravlja što se tiče elektromagnetske kompatibilnosti opreme (i njezinih izmjena i dopuna).

- Direktive o buci u okolišu uzrokovane opremom za uporabu na otvorenom (OND): 2000/14/EZ, DODATAK VI. - 2005/88/EZ; Certifikacijsko tijelo: N°0197-TÜV Rheinland LGA Products GmbH Tillystrasse 2, 90431 Nürnberg – Germany;

Sukladnost s usklađenim normama:

- EN ISO 5395-1:2013;
- EN ISO 5395-3:2013;
- EN 55012:2007/A1:2009
- EN ISO 14982:2009

- Osim toga, izjavljujemo da je dolje potpisani Ferrari Claudio, kao predsjednik tvrtke “OFFICINE BIEFFEBI S.p.A.” sa sjedištem u via dell’ Artigianato 7, 46023, Gonzaga (Mn) - ITALIJA, odgovorna osoba za sastavljanje i čuvanje tehničke dokumentacije.

HU

MEGFELEL AZ ALÁBBI EURÓPAI IRÁNYELVEKBEK FOGLALT RENDELKEZÉSEKNEK:

- (többször módosított és kiegészített) 2006/42/EK Gépekről szóló irányelv, valamint annak nemzeti végrehajtási rendeletei (*).
- (*) Megfelelőség értékelési eljárás: VIII. melléklet

- 2014/30/EU irányelv: az elektromágneses összeférhetőségre vonatkozó alapvető biztonsági és egészségügyi követelmények (valamint módosításai és kiegészítései).

- OND: 2000/14/EK, VI. MELLÉKLET - 2005/88/EK;

Tanúsító szerv: N°0197-TÜV Rheinland LGA Products GmbH Tillystrasse 2, 90431 Nürnberg – Germany;

Harmonizált jogszabályok:

- EN ISO 5395-1:2013;
- EN ISO 5395-3:2013;
- EN ISO 55012:2007/A1:2009;
- EN ISO 14982:2009;

- Kijelentjük továbbá, hogy alulírott Ferrari Claudio mint az „OFFICINE BIEFFEBI S.p.A.” cég elnöke – székhelye 46023, Gonzaga (Mn) via dell’ Artigianato 7, OLASZORSZÁG – felelős a műszaki dokumentáció összeállításáért és őrzéséért.

LT

ATITINKA ŠIŲ EUROPOS SĄJUNGOS DIREKTYVŲ ATITINKAMAS NUOSTATAS:

- Mašinių direktyvos 2006/42/EB (su pakeitimais ir papildymais) ir nacionalinių lygiu igyvendinamų nuostatų (*).
- (*) Atitikties įvertinimo procedūra: VIII priedas

- Direktyvos 2014/30/ES: saugos ir sveikatos esminius reikalavimus, susijusius su įrenginių elektromagnetiniu suderinamumu (su pakeitimais ir papildymais).

- Skleidžiamo triukšmo standartų: 2000/14/EB, VI PRIEDAS – 2005/88/EB;

Sertifikavimo įstaiga: N°0197-TÜV Rheinland LGA Products GmbH Tillystrasse 2, 90431 Nürnberg – Germany;

Nuoroda į darniuosius standartus:

- EN ISO 5395-1:2013;
- EN ISO 5395-3:2013;
- EN 55012:2007/A1:2009
- EN ISO 14982:2009

- Taip pat patvirtinama, kad, toliau pasirašiusysis Claudio Ferrari, veikiantis kaip bendrovės „OFFICINE BIEFFEBI S.p.A.“, esančios via dell’ Artigianato 7, 46023, Goncagoje (Mn), Italijoje, direktorius yra atsakingas už techninės bylos sudarymą ir saugojimą.

LV

SASKAŅĀ AR ŠĀDU EIROPAS DIREKTĪVU NOTEIKUMIEM:

- Direktīvu “parmašīnām” 2006/42/EK (arturpmākiemgrozijumiem un papildinājumiem) un attiecīgās valsts likumdošanas aktiem (*).
- (*) Atbilstības novērtēšanas procedūra: VIII pielikums

- Direktīvu 2014/30/ES: veselības un drošības pamatprasības attiecībā uz iekārtu elektromagnētisko savietojamību (ar turpmākiem grozijumiem un papildinājumiem).

- OND: 2000/14/EK, VI PIELIKUMS - 2005/88/EK;

Sertifikācijas iestāde: N°0197-TÜV Rheinland LGA Products GmbH Tillystrasse 2, 90431 Nürnberg – Germany;

Atsauce uz saskaņotajiem standartiem:

- EN ISO 5395-1:2013;
- EN ISO 5395-3:2013;
- EN 55012:2007/A1:2009
- EN ISO 14982:2009

- Turklāt, tiek precizēts, ka apakšā parakstījis Ferrari Claudio kā uzņēmuma “OFFICINE BIEFFEBI S.p.A.”, kas atrodas via dell’ Artigianato 7, 46023, Gonzaga (Mn) - ITALIJA priekšsēdētājs, ir atbildīgs par tehniskās dokumentācijas sastādīšanu un uzglabāšanu.

ER I SAMSVAR MED DE RELEVANTE BESTEMMELSENE I FØLGENDE STANDARDER:

- Maskindirektiv 2006/42/CE (og etterfølgende endringer og tillegg) og gjeldende nasjonale disposisjoner (*).
- (*) Vurderingsprosedyre for samsvar: Vedlegg VIII
- Direktiv 2014/30/EU: grunnleggende krav til sikkerhet og helse i forbindelse med elektromagnetisk kompatibilitet av utstyr (og etterfølgende endringer og tillegg).
- OND: 2000/14/EC, ANNEX VI - 2005/88/EC;
- Sertifiseringsorgan: N°0197-TÜV Rheinland LGA Products GmbH Tillystrasse 2, 90431 Nürnberg – Germany;

Referanse til harmoniserte normer:

- EN ISO 5395-1:2013;
- EN ISO 5395-3:2013;
- EN 55012:2007/A1:2009
- EN ISO 14982:2009
- I tillegg er det fastsatt at undertegnede, Claudio Ferrari som administrerende direktør av "WORKSHOP BIEFFEBI S.p.A.» med hovedsete i Artigianato 7, 46023, Gonzaga (Mn) - ITALIA, er ansvarlig for å utarbeide og oppbevare den tekniske dokumentasjonen.

JEST ZGODNA Z NASTĘPUJĄCYMI DYREKTYWAMI EUROPEJSKIMI:

- Dyrektywamaszynową2006/42/WE (wraz z późniejszymi zmianami i uzupełnieniami) i krajowymi przepisami wykonawczymi (*).
- (*) Procedura oceny zgodności: Załącznik VIII
- Dyrektywa 2014/30/UE: w sprawie harmonizacji ustawodawstw państw członkowskich odnoszących się do kompatybilności elektromagnetycznej (wraz z późniejszymi zmianami i uzupełnieniami).
- OND: 2000/14/WE, ZAŁĄCZNIK VI - 2005/88/WE;
- Jednostka certyfikująca: N°0197-TÜV Rheinland LGA Products GmbH Tillystrasse 2, 90431 Nürnberg – Germany;

Odniesienie do norm zharmonizowanych:

- EN ISO 5395-1:2013;
- EN ISO 5395-3:2013;
- EN 55012:2007/A1:2009
- EN ISO 14982:2009
- Ponadto wskazuje się, że niżej podpisany Ferrari Claudio, jako prezes spółki „OFFICINE BIEFFEBI S.p.A.”, z siedzibą pod adresem via dell' Artigianato 7, 46023, Gonzaga (Mn) - ITALY, jest odpowiedzialny za sporządzenie i przechowywanie dokumentacji technicznej.

ESTÁ CONFORME COM AS NORMAS PERTINENTES DAS SEGUINTES DIRETIVAS EUROPEIAS:

- Diretiva “Máquinas” 2006/42/CE (e posteriores alterações e aditamentos) e normas nacionais de execução (*).
- (*) Procedimento de avaliação da conformidade: Anexo VIII
- Diretiva 2014/30/UE: requisitos essenciais de segurança e saúde relativos à compatibilidade eletromagnética dos aparelhos (e posteriores alterações e aditamentos).
- OND: 2000/14/CE, ANEXO VI - 2005/88/CE;
- Órgão certificador : N°0197-TÜV Rheinland LGA Products GmbH Tillystrasse 2, 90431 Nürnberg – Germany;

Referência às normas harmonizadas:

- EN ISO 5395-1:2013;
- EN ISO 5395-3:2013;
- EN 55012:2007/A1:2009
- EN ISO 14982:2009
- Informa-se que Ferrari Claudio, abaixo-assinado na qualidade de diretor-geral da empresa “OFFICINE BIEFFEBI S.p.A.”, com sede em via dell' Artigianato 7, 46023, Gonzaga (Mn) - ITALY, é responsável pela elaboração e conservação de toda a documentação técnica.

SA ZHODUJE S NARIADENIAMI VYPLÝVAJÚCIMI Z NASLEDOVNÝCH EURÓPSKÝCH SMERNÍC

- Smernice „Stroje“ 2006/42/ES (v znení neskorších úprav a doplnkov) a vnútroštátnych vyhlášok (*).
- (*) Proces posudzovania zhody Príloha
- Smernica 2014/30/EÚ: základné požiadavky na bezpečnosť a ochranu zdravia v oblasti elektromagnetickej kompatibility zariadení (v znení neskorších úprav a doplnkov).
- OND: 2000/14/EC, ANNEX VI - 2005/88/EC;
- Ustanova, ki izda potrdilo: N°0197-TÜV Rheinland LGA Products GmbH Tillystrasse 2, 90431 Nürnberg – Germany;

ref. harmonizované normy:

- EN ISO 5395-1:2013;
- EN ISO 5395-3:2013;
- EN 55012:2007/A1:2009
- EN ISO 14982:2009
- Ďalej sa špecifikuje, že dolupodpisany Claudio Ferrari ako prezident firmy „OFFICINE BIEFFEBI a.s.“ sídliacej na adrese via dell' Artigianato 7, 46023, Gonzaga (Mn) – Taliansko zodpovedá za zriadenie a uchovávanie technickej knižky

U SKLADU JE SA EVROPSKIM ODREDBAMA KOJE SLEDE:

- Odredba „Mašine” 2006/42/CE (i naknadne izmene i dopune) i nacionalne odredbe (*).
- (*) Procedura za procenu usklađenosti: U prilogu VIII
- Odredba 2014/30/EU: osnovni uslovi bezbednosti i zdravlja vezani za elektromagnetnu kompatibilnost aparata (i naknadne izmene i dopune).

— OND: 2000/14/EC, ANEKS VI - 2005/88/EC;

Sertifikaciono telo: N°0197-TÜV Rheinland LGA Products GmbH Tillystrasse 2, 90431 Nürnberg – Germany;

Upućivanje na usklađene norme:

- EN ISO 5395-1:2013;
- EN ISO 5395-3:2013;
- EN 55012:2007/A1:2009
- EN ISO 14982:2009
- Pored toga, precizira se da dolepotpisani Ferrari Claudio, direktor firme „OFFICINE BIEFFEBI S.p.A.” sa sedištem u via dell' Artigianato 7, 46023, Gonzaga (Mn) - ITALIJA je odgovorno lice za izradu i čuvanje tehničke brošure.

Fatto a - Made in - Fait à - Innet gebildet - Fabricado en

Made in - Gefabriceert in - Valmistettu - Tillverkad i

Sepsáno v - Sastavljeno u - Készült - Sudaryta - Sastādīts

Utført i - Sporządzono w - Feito em - Miesto - Mesto

GONZAGA (MN) ITALY

li - on - le - den - en fecha - Den - Op

Päiväys - Den - v - dana - Datum - datums

dato - dnia - aos - dňa -

.....

FERRARI CLAUDIO

PRESIDENT OF

OFFICINE BIEFFEBI S.P.A.

Firma - Signature - Signature - Unterschrift - Firma
Underskrift - Handtekening - Allekirjötus - Namnteckning
Podpis - Allkiri - Potpis - Allárás - Parašas - Paraksts
Underskrift - Podpis - Emoesa - Podpis - Potpis



GENERAL WARRANTY CONDITIONS

The STIGA® product you have purchased was designed and manufactured with advanced technology to guarantee the highest quality and reliability over time.

Before delivery, the STIGA® dealer has carried out a series of checks and controls and has provided you with all the information required to properly use and maintain the product.

The main checks and controls carried out by the dealer before handing over the machine include:

- controls, technical checks and adjustments for the operational start-up;
- checking the oil level and level of other liquids;
- hand-over of the operator's manual, complete with EC declaration of conformity;
- hand-over of the documentation regarding the engine;
- illustration of the functioning of the product;
- illustration of the functioning of safety devices / components;
- illustration of the importance of regular and scheduled maintenance;
- illustration of the warranty conditions.

1. DURATION OF THE WARRANTY

The manufacturer's warranty does not penalize the legal rights of the Purchaser in relation to the Seller (Dealer) and provides additional information compared to the information provided by the Seller (Dealer) in relation to the sales contract. Without prejudice to the guarantees enshrined in the applicable local legislation, and unless the law stipulates a longer period, STIGA guarantees its product for a period of:

- 2 years for private users (consumers);
- 1 year in all other cases.

By private user (consumer) what is meant is any natural person who is acting for purposes which are not related to his trade, business or profession.

The engine has a separate warranty, as shown by the dedicated documentation. Management of the engine warranty (and its components) is the exclusive responsibility of the Technical Support Department of the engine manufacturer.

2. WARRANTY COVER

During the warranty period, via its Dealer, the technical staff of STIGA shall repair or replace without charge any component which proves to be defective, whether a manufacturing or material defect. The repair or replacement work of the defective component does not prolong or renew the warranty period. The warranty covers the product only if it has been used for the purposes for which it was designed and in compliance with the instructions in the operator's manual supplied with the machine.

3. WARRANTY EXCLUSIONS

The warranty is not valid if the defect is caused by:

- lack of care;
- bad or improper use;
- poor treatment;
- maintenance not carried out at the times and in the ways specified in the operator's manual;
- an accident;
- the use of non-original spare parts;
- modifications not authorized by STIGA.

Damage following bumping or caused by stones or foreign bodies in the work area is not covered by warranty.

The normal wear and tear of parts such as filters, oil, spark plugs, tyres, belts, blades etc. is not covered by warranty.

INDEX

NOTES FOR THE DISPOSAL OF THE PRODUCT VALID FOR THE EUROPEAN COMMUNITY	27
0. NAMEPLATE CE	27
1. SERIAL NUMBER	27
2. TO OUR COSTUMERS	27
3. INTENDED PURPOSE	27
4. FORBIDDEN FORESEEABLE USE	27
5. USER'S RESPONSIBILITY	28
6. SAFETY STANDARDS	28
6.1 SLOPES	29
6.2 TRANSPORT AND UNLOADING	29
7. TECHNICAL FEATURES	30
7.1 MACHINE WEIGHTS.....	30
7.2 COMPATIBLE IMPLEMENTS	30
7.3 NOISE	30
7.4 VIBRATIONS	30
8. CONTROLS AND INSTRUMENTS.....	31
9. ASSEMBLING THE EQUIPMENT	31
9.1 ASSEMBLING THE MULCHING PLATE	31
9.2 ACCESSORIES ASSEMBLING	31
9.3 SEAT ASSEMBLING.....	31
10. USING CONTROLS AND INSTRUMENTS	31
10.1 FORWARD - REVERSE	31
10.2 PARKING BRAKE.....	31
10.3 BY-PASS	31
10.4 HAND THROLLE.....	31
10.5 P.T.O	31
10.6 PLATE HEIGHT ADJUSTMENT.....	31
10.7 BASKET LIFTING	31
10.8 FUEL TAP.....	31
10.9 PLATE HEIGHT ADJUSTMENT.....	31
10.10 TOW HOOK.....	31
11. WIRING DIAGRAM.....	31
11.0 COLOUR PALETTE.....	31
11.1 BRIGGS & STRATTON.....	32
12. STARTING THE ENGINE.....	32
13. DRIVING THE MACHINE	32
14. CUTTING GRASS	32
14.1 REAR DISCHARGE OF THE GRASS	32
15. STOPPING THE ENGINE.....	32
16. TANK FILLING.....	32
17. ORDINARY MAINTENANCE	33
17.1 ADD MOTOR OIL.....	33
17.2 ENGINE OIL REPLACEMENT	33
17.3 BATTERY.....	33
17.4 FUSES.....	33
17.5 AIR FILTER	33
17.6 ENGINE OIL FILTER	33
17.7 CARBURANT FILTER.....	33
17.8 TYRE PRESSURE	33
17.9 DECK VERTICAL POSITIONING KIT	33
17.10 CLEANING THE MACHINE.....	33
17.11 GREASING.....	33
17.12 CHANGING/MAINTENANCE BLADES	33
17.13 TRANSAXLE OIL CHANGE.....	33
17.14 TRANSAXLE FILTER CHANGE.....	33
18. EXTRAORDINARY MAINTENANCE	33
19. INACTIVITY OF THE MACHINE	33
20. SAFETY STICKERS	34
21. NOTES	34
22. TABLE MAINTENANCES	34
23. TROUBLESHOOTING.....	34

NOTES FOR THE DISPOSAL OF THE PRODUCT VALID FOR THE EUROPEAN COMMUNITY



Do not dispose the product as a solid urban waste but dispose it by dropping it at a dumping site. By salvage dumping the product you risk to pollute the nature. If the product is provided with a battery, you must dump the battery in a separate container as the battery contains highly toxic substances. The above shown figure represent a local garbage bin. It is absolutely forbidden to throw the product in such a bin.

EN

0. NAMEPLATE CE

See figure 0.

The label is for guidance only, refer to the one affixed to the machine.

- | | | |
|---------------------------|--|------------------------|
| 1) Manufacturer's address | 4) Mark of CE Conformity | 7) Construction's year |
| 2) Machine type | 5) Weight in kg (with empty fuel tank) | 8) Serial number |
| 3) Sound power level | 6) Power and engine operating speed | 9) Article Code |

1. SERIAL NUMBER

See figure 1.

2. TO OUR CUSTOMERS

We are pleased to welcome you as one of our customers. To ensure best possible performance of your machine as well as for useful tips for using and maintaining it, we kindly ask you to read through carefully the User's Manual. The machines MPV can be fitted with various equipments: it is therefore important that the user studies, in addition to this manual, also the manual referring to the equipment that he intends to mount on his machine. The machine has been designed to give best performance under difficult conditions. Its working performance largely depends of course on its maintenance. Should queries arise that have not been dealt with in these instructions, then please contact your dealer who will be able to assist you further.



THIS SIGN IMPLIES THAT SAFETY REGULATIONS MUST BE COMPLIED WITH AT ALL TIMES BY THE USER SO AS TO AVOID ACCIDENTS. PLEASE, BE CAREFUL WHEN YOU SEE THIS SIGN. IT IS FOR YOUR AND OTHER PEOPLE'S SAFETY.

3. INTENDED PURPOSE

This machine is a gardening equipment, and precisely a mower with seated driver and front cut.

This machine is intended for use by consumers, non-professional operators. This machine is designed for a "hobby use".

The most common possibilities of use are:

- Mower deck rear loading
- Mulching mower deck
- Rear discharge
- Snow blade
- Front Sweeper

We decline any responsibility if the machine is used with any implement different to those mentioned in this manual.

4. FORBIDDEN FORESEEABLE USE

Any use not mentioned in paragraph "Intended Purpose" is not allowed.

The use of any implement not mentioned in this manual is considered as improper and dangerous as not controlled by us for risks of use.

Transportation of persons (except the driver), objects or animals is not allowed.

It is absolutely forbidden to use the machine without having read this manual.

Transformations and modifications to the machine not mentioned in this manual are absolutely not allowed.

It is absolutely not allowed to use the machine if it is not in perfect working condition therefore precede to all necessary controls and maintenance recommended.

Do not allow children and adolescents to use the machine.

Do not use the machine with sandals or bare-foot.

It is absolutely forbidden to use the machine as a hoist.

It is forbidden to use the machine with badly assembled implements.

Never start the engine in a closed room. Exhaust fumes are poisonous.

Before carrying out maintenance operations on the machine make sure that the same is off.

Before intervening on the electrical installation, disconnect the power cables from the battery terminals.
Be careful that flames or sparks do not get near the petrol tank.
It is strictly forbidden to tamper with the machine's speed control seals.
Do not use the machine in bad weather, especially in the presence of lightning.
Never park on slopes.

5. USER'S RESPONSIBILITY

It is imperative that the user reads through this manual carefully so as to become acquainted with its working procedure, maintenance of parts and proper lubrication according to our instructions. The user is also responsible for checking, repairing and for possible replacement of wornout parts which could cause injuries. The user is responsible for damages caused to third parties by improper use. The machine must be used and maintained only by persons with a good knowledge of its specific features and who have fully understood the safety rules. Never let children or minors near the machine. Local laws, if any, may state a minimum age for the operator. Never take passengers. Only factory approved attachments and accessories are permitted. It is strictly prohibited to do any alterations or reconstructions to the machine which are not mentioned in this manual.

WHEN USING THE MACHINE, THE OPERATOR MUST SCRUPULOUSLY OBSERVE THE SAFETY RULES CONTAINED IN THIS MANUAL, THE RULES FOR THE PREVENTION OF ACCIDENTS, OTHER GENERAL SAFETY RULES, THE PROVISIONS OF WORK MEDICINE.

6. SAFETY STANDARDS

ONLY A CAREFUL USER IS A GOOD USER

If you follow the Safety Instructions in the manual you can avoid accidents.

MAIN PART

- 1) Read through carefully each section of these instructions. It is strictly forbidden the use of the machine to the staff who have not read and understood this manual.
- 2) Check the machine before every use for defect, for e.g. loose screws and bolts, loosened or damaged blades or other parts which are not secure. It is absolutely forbidden to use the machine in improper conditions. Therefore, before starting your machine go through the control and service instructions as recommended.
- 3) Before starting the machine acquaint yourself with all the parts and with the checking system.
- 4) The machine should only be used by adults with experience. Don't let children use it. Avoid using the machine if you do not feel physically fit for the job.
- 5) **Keep people within a certain security distance as explained hereafter.**
- 6) Only use original parts and accessories. Do not make any changes thereto. For information, please consult your dealer.
- 7) Replace lost or damaged safety stickers or warning labels. Check the list of safety stickers in the "SAFETY PRE CAUTIONS" section of this manual. Wipe dust and dirt off the stickers.
- 8) Keep hands and feet, as well as your body away from the moving parts.
- 9) Never use the machine without protection and covers in the right position and perfect condition. Do not use the machine if its safety devices are not perfectly efficient. For no reason, tamper with the machine safety devices.
- 10) Should an object have been run over or got stuck, stop immediately. Turn off the engine and remove the ignition key. Disengage the P.T.O., put the attachment onto the ground and inspect it. Do not start using the machine until you are sure that it is in perfect working order.
- 11) When you have finished working with the machine, disengage the P.T.O., put the attachment lower down so that it touches the ground, turn off the engine and remove the key.
- 12) Before carrying out maintenance operations on the machine make sure that the same is off. Before intervening on the electrical installation, disconnect the power cables from the battery terminals.
- 13) Machine speed should be suited to the ground you are working on.
- 14) Working on slopes requires extreme caution and reduced speed.
- 15) In the use and maintenance of the machine must wear protective clothing: goggles, gloves, **safety shoes and sturdy shoes** and other protective clothing.

- 16) Only use the machine with good visibility.
- 17) All drivers should receive a professional and practical training. Such training should highlight the following:
- the necessity of paying attention and being concentrated when working on machines where the driver is sitting.
 - a machine sliding down a slope can be brought again under control by pulling the brakes. The main causes for the loss of control are:
 - a) insufficient grip of the wheels;
 - b) driving too fast;
 - c) inadequate braking;
 - d) type of machine unsuitable for the job required;
 - e) lack of awareness of the effect of the condition of the ground, particularly of slopes ;
 - f) the equipments are wrongly attached and the loads are consequently badly distributed.
- 18) During the phases of work, always wear strong shoes and long trousers. Do not use the machine when you are bare-footed or wearing sandals.
- 19) Inspect thoroughly the area where the machine is to be used and remove all the object that could be thrown by the machine.
- 20) Always disengage the P.T.O.* when transferring the machine.
- 21) Every time the user leaves, even temporarily, the machine must apply the parking brake.
- 22) During the step of reversing pay close attention to obstacles and in particular to persons.

6.1 SLOPES See figure 6.1

- Do not use the machine on longitudinali slopes of more than 15°.
- Do not use the machine on lateral slopes higher of more than 10°.
- Do not proceed on slopes of any kind (lateral or longitudinal) with the deck and basket lifted.
- Do not stop or start suddenly the machine when going up or down a slope.
- Proceed with low speed on slopes or narrow curves.
- Pay attention to any road humps, potholes or other hidden dangers. If the ground is irregular, the machine can overturn more easily.
- Do not operate in the proximity of shoulders, ditches or river banks; the machine could suddenly overturn if a wheel goes beyond the edge of the latter, or if the shoulder cedes.

6.2 TRANSPORT AND UNLOADING See figure 6.2

The machine is heavy and can cause serious crushing damages.

Load and unload it with care and use loading ramps.

Transport the machine on a homologated trailer. During transport, use the the parking brake and fix the machine with homologated devices, such as belts, chains or ropes.

N.B.: If the machine is packed and mounted on its pallet, it is possible to move it with a forklift.

CAPACITY 440 Kg



IMPORTANT:

The parking brake is not sufficient for locking the machine during transport. Fix appropriately the machine to the vehicle with homologated devices.

7. TECHNICAL FEATURES

See figure 7.

Type	FMC 112	
Model	MPV 320W	MPV 520W
Engine	Vanguard 16 V-Twin (305777)	Vanguard 21 V-Twin (385777)
Engine revs (min ⁻¹)	2400	2400
Engine power (kW)	7,75	10,84
Displacement (cm ³)	480	627
N° of cylinders	2	2
Spark plug	Champion XC12YC	
Driving wheels	Front	
Type of progress	Hydrostatic	
Service brake	Hydrostatic	
Parking brake	Disk brake	
Max speed (Km/h)	7	
Fuel tank (L)	19	
Blade	DX - 87001000014 SX - 87001000013	
Mulching Blade	DX - 2655 SX - 2658	
Part number GGP	DX - 118830014/0 SX - 118830015/0	
Rotating blades	Rotating by electromagnetic clutch	
Cutting height regulation (cm)	2 ÷ 8	
Width of cut (mm)	1120	

7.1 MACHINE WEIGHTS

Model	Mass with empty tank (kg)
MPV 320W	387
MPV 520W	387

7.2 COMPATIBLE IMPLEMENTS

- Snowploughs blade: SNB 1601
- Front Sweeper: SWR 1603
- Plate mower 112 C

7.3 NOISE

Noise level	100 dB (A) ± 0,7
Noise pressure at operator's seat	83 dB (A) ± 1,89
Guaranteed power sound level	100 dB (A)

7.4 VIBRATIONS

- Exposition of acceleration of superior limbs: 2 m/s² ± 0,85
- Exposition of body acceleration: 0,7 m/s² ± 0,21

8. CONTROLS AND INSTRUMENTS

See figure 8.

The machine includes the following controls:

- | | | |
|------------------------------------|------------------------------------|--|
| 1) Steering wheel | 7) P.T.O. and turbine engagement | 13) Forward speed pedal - reverse gear |
| 2) Parking brake | 8) Accelerator | 14) Engine choke control |
| 3) Adjusting the longitudinal seat | 9) Lever for lifting the equipment | 15) Hourmeter |
| 4) By-pass lever | 10) Light switch | 16) Vain clean tunnel |
| 5) Plate height adjustment | 11) Switch key | |
| 6) Elevator activating basket | 12) Fuel tap | |

EN

9. ASSEMBLING THE EQUIPMENT

9.1 ASSEMBLING THE MULCHING PLATE

See figure 9.1

- 1) Let the lifting arms of the engine couple with the attachments present on the equipment
- 2) Insert the locking pins and the safety split pins
- 3) Loosen the belt tensioner.
- 4) Mount the belt.

9.2 ACCESSORIES ASSEMBLING

See figure 9.2

For accessories assembling, refer to the separate installation guide supplied with each accessory

9.3 SEAT ASSEMBLING

See figure 9.3

- 1) The seat is supplied already assembled with the upper guides.
- 2) Connect the micro of the seat with the electrical system connector.
- 3) Slide the seat from the front of the rails bolted to the plate.
- 4) Screw the travel stop screw forward.

10. USING CONTROLS AND INSTRUMENTS

10.1 FORWARD - REVERSE

See figure 10.1

10.2 PARKING BRAKE

See figure 10.2

10.3 BY-PASS

See figure 10.3



IMPORTANT:

Avoid towing the machine for long stretches with inserted by-pass.

10.4 HAND THROLE

See figure 10.4

10.5 P.T.O

See figure 10.5

- 1) To INSERT the PTO push up the Red Security tab and, simultaneously, PRESS the button.
- 2) To disengage the PTO PRESS Again the button.

10.6 PLATE HEIGHT ADJUSTMENT

See figure 10.6

Pay attention to possible crushing, use the special lifting handles.

10.7 BASKET LIFTING

See figure 10.7

10.8 FUEL TAP

See figure 10.8

10.9 PLATE HEIGHT ADJUSTMENT

See figure 10.9

10.10 TOW HOOK

See figure 10.10

11. WIRING DIAGRAM

11.0 COLOUR PALETTE

A Sky-blue	G Yellow	M Brown	S Pink
B White	H Grey	N Black	V Green
C Orange	L Blue	R Red	Z Violet

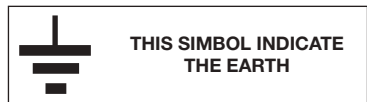

11.1 BRIGGS & STRATTON

See figure 11.1

RIF.	DESCRIPTION
A	Ignition Switch
B	Full Load Buzzer Hopper
C	PTO switch
D	Headlights Switch
E	Headlights
F	Headlights
G	PTO clutch
H	Hopper Full Switch
L	Motor
M	Motor Connector
N	Close Hood Micro Switch
N1	Micro Left Side Safety
N2	Micro Accelerator Pedal Security
O	Basket Closed Microswitch

P	Seat Switch
R	Parking Brake Microswitch
R1	PTO Starter Consent Relay
R2	PTO Safety Relay
R3	Starter Enable From Safety Relay
R4	Motor Stop Relay
R5	Hourmeter Relay
R6	PTO Relay
R7	Motor stop safety relay
S	Grounding
T	Hourmeter
V	Diode for PTO clutch relay
Y	PTO Fuse
Z	Fusibile protezione impianto
R8	Starter solenoid

12. STARTING THE ENGINE

See figure 12.

- 1) Take your place correctly on seat
- 2) Make sure that the parking brake is entirely engaged
- 3) Set engine choke control to for cold starts and turn the ignition key to the "ON" position
- 4) Turn the ignition key onto the symbol to start the motor
- 5) Slowly return choke to run position once the engine has started

13. DRIVING THE MACHINE

See figure 13.

- 1) Set throttle lever.
- 2) Disengage the parking brake.
- 3) Select the desired speed through the pedal fitted on the right side.
- 4) By moving the steering wheel one steers the front wheel.

N.B.: To stop the machine, just release the forward or reverse pedal; once stopped, engage the parking brake.



IMPORTANT: To be driven at slow speed, for safety reasons make sure that people and animals are at least 3 meters away

14. CUTTING GRASS

See figure 14.

14.1 REAR DISCHARGE OF THE GRASS

See figure 14.1

15. STOPPING THE ENGINE

- 1) Stop the machine.
- 2) Declutch the PDP.
- 3) Engage the parking brake.
- 4) Reduce the motor revolution on minimum.
- 5) Turn the ignition key from "ON" position to "STOP" position.

16. TANK FILLING

See figure 16.

Only fill the tank in open air or in a sufficiently ventilated room. The engine must be turned off and no flames or sparks should be made. Check that carburant is the one indicated by the label on the tank.

WARNING: CARBURANT IS HIGHLY INFLAMMABLE.

KEEP THE CARBURANT IN JERRYCANS. FILL THE TANK WITH PETROL ONLY IN OPEN AIR AND DO NOT SMOKE DURING THIS OPERATION. ADD CARBURANT BEFORE STARTING THE ENGINE. NEVER REMOVE THE TANK LID NOR ADD CARBURANT WHEN THE ENGINE IS WORKING OR IS HOT.

In case of carburant escape, do not try to start the engine but move the machine away from the place where the escape took place and avoid creating ignition sources until carburant fumes have dissipated. Replace the correct lids on the tank and the jerrycan. Never store the machine with carburant in the tank inside a building where the fumes might reach some free flames or sparks. Let the engine cool down before storing the machine in any closed environment.

17. ORDINARY MAINTENANCE

If you have to carry out maintenance operations, use only original spare parts, to ensure the same maximum reliability to the machine. Before carrying out any maintenance work, read carefully the indications given in the paragraph 6 "Safety rules". Periodically check the functionality of all machine's commands and controls.

17.1 ADD MOTOR OIL See figure 17.1

• BRIGGS & STRATTON

Consult the Use and Maintenance manual of the motor.

OIL 10W-40

17.2 ENGINE OIL REPLACEMENT See figure 17.2

17.3 BATTERY See figure 17.3

The battery fluid should not be checked or topped up.

17.4 FUSES See figure 17.4

17.5 AIR FILTER See figure 17.5

Periodical checks.

17.6 ENGINE OIL FILTER See figure 17.6

Consult the use and maintenance manual of the motor.

17.7 CARBURANT FILTER See figure 17.7

17.8 TYRE PRESSURE See figure 17.8

If the front tires are inflated at different pressure, the blades will mow the grass at different heights

17.9 DECK VERTICAL POSITIONING KIT See figure 17.9

17.10 CLEANING THE MACHINE See figure 17.10

17.11 GREASING See figure 17.11

See tab. maintenance.

17.12 CHANGING/MAINTENANCE BLADES See figure 17.12

17.13 TRANSAXLE OIL CHANGE See figure 17.13

- Oil 20W-50

17.14 TRANSAXLE FILTER CHANGE See figure 17.14

18. EXTRAORDINARY MAINTENANCE

For the extraordinary maintenance of the machine, contact only an authorised service center.

19. INACTIVITY OF THE MACHINE

In case the MPV machine has to remain idle for a long period of time, it is convenient to carry out some operations to ensure its efficiency when reused and the duration of the same for years:

-Carry out all the indications given in the use and maintenance manual of the motor prearrange the same for "out of service".

-Remove the battery, recharge it and store it in a dry and ventilated place.

-Clean carefully the engine with an eye in particular where there are incrustations due to soil and grass residues.

-Carry out the of "ordinary maintenance" operations described above and, if necessary, carry out also the "extraordinary maintenance".

-Park the engine in a dry and ventilated place and cover it with a suitable non-impermeable protection sheet.

-During the period of inactivity, always maintain the pressure indicated for the tyres and, periodically, change the resting point of the tyres on the ground.

- Clear a tank of fuel.

- Closed fuel tap.

20. SAFETY STICKERS

See figure 20.

Description Safety labels

Decal No. 1 shows:

- General danger signal;
- Danger of launch objects during operation;
- Read the instruction manual,
- Maintain a distance of respect from the machine in operation;
- Danger of tipping side slopes greater than 10 °;
- Danger of tipping in the direction of travel for more than 15 ° slope;

Decal No. 2 indicates:

Danger of cutting fingers and feet.

Decal No. 3:

Eye protection requirement.

Decal No. 4:

Hearing protection requirement.

Decal No.5 indicates:







Weight of mulching plate.

21. NOTES

A) Please contact our authorised dealer for anything that is not dealt with in this manual.

B) Always keep this technical handbook in a safe place for future reference. It can be modified without prior notice or any additional obligations in order to improve the product. Reproduction or translation of any part of this manual is not allowed without the owner's prior written consent.

22. TABLE MAINTENANCES

MAIN MAINTENANCE OPERATIONS	FIRST CHECK HOURS	INTERVAL					NOTES	FIG.
		DAILY	WEEKLY	EVERY 50 HOURS	EVERY 100 HOURS	EVERY 400 HOURS		
OVERHALL CLEANING		X						17.10
ACCURATE GENERAL CLEANING			X					17.10
GREASING				X				17.11
AIR FILTER CLEANING		X+						17.5
MOTOR OIL LEVEL		X						17.1
MOTOR OIL CHANGE	5				X			17.2
MOTOR OIL FILTER CARTRIDGE CHANGE	5				X			17.6
CARBURATEUR FILTER CHANGE					X			17.7
AIR FILTER CHANGE				X+				17.5
TRANSAXLE FILTER CHANGE	75					X		17.14
TRANSAXLE OIL CHANGE	75					X		17.13
MOTOR MAINTENANCE								
MOWER BLADES CHECK		X+						17.12
TYRES PRESSURE CHECK			X					17.8
CHECK BELT TENSIONER SPRING			X					
WHEEL BOLTS TIGHTENING CHECK			X				91±2 Nm	17.8

+ In case of particularly heavy working conditions, these operation must be carried more frequently.

 Motor maintenance: check the motor operating and maintenance manual.

23. TROUBLESHOOTING

If you are experiencing a problem that is not listed in this chart, see your authorized dealer for service. When you have checked all the possible causes listed and you are still experiencing the problem, see your authorized dealer.

Engine

IF	CHECK
Poor engine performance	Dirt in fuel system or fuel is old, fuel filter and air filters are dirty.
Engine will not start	Man is not in his seat. Parking brake off. Engine compartment is open or not correctly closed. Fuel shutoff valve is in OFF position. Out of fuel or improper fuel. Plugged fuel filter. Electrical problem - See Electrical Troubleshooting section.
Engine is hard to start	Improper use of choke. Plugged fuel filter. Stale or improper fuel.
Engine runs unevenly	Choke not fully off. Fuel line or fuel filter plugged. Stale or dirty fuel. Air cleaner element plugged.
Engine misses under load	Choke not fully off. Stale or dirty fuel. Plugged fuel filter.
Black exhaust smoke	Choke not fully off. Air filter element is dirty.

EN

Electrical

IF	CHECK
Starter does not engage	Brake parking is not depressed. Battery not charged. Fuse is blown. Man is not in his seat.

Machine

IF	CHECK
Machine will not move with engine running	Transaxle bypass valve plate is in engaged position. Drive belt broken or damaged.

ILLUSTRAZIONI E SCHEMI
ILLUSTRATIONS AND DIAGRAMS
ILLUSTRATIONS ET SCHÉMAS
BILDER UND ZEICHNUNGEN
ILLUSTRATIES EN DIAGRAMMEN
ILUSTRACIONES Y ESQUEMAS
VAROITUSTARRAT JA KUVAT
DIAGRAMTEGNINGER
ILLUSTRATIONER
ILUSTRACE A SCHÉMATA
ILLUSTRATSIOONID JA JOONISED
ILUSTRACIJE I SHEME
ÁBRÁK ÉS RAJZOK
ILIUSTRACIJOS IR SCHEMOS
ATTĒLI UN SHĒMAS
ILLUSTRASJONER OG SKJEMAER
ILUSTRACJE I SCHEMATY
FIGURAS E ESQUEMAS
ILUSTRÁCIE A SCHÉMY
ILUSTRACIJE I SKICE

0.

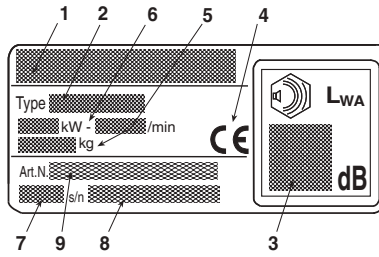

1.

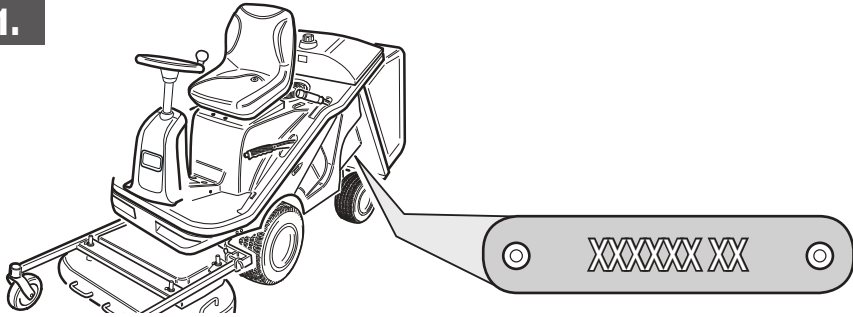

6.1

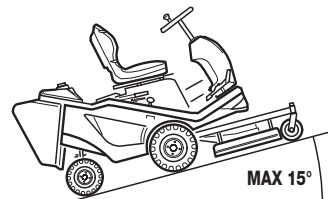
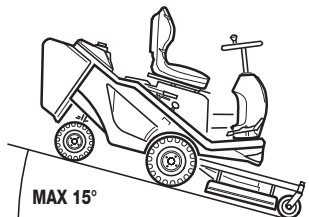

6.2

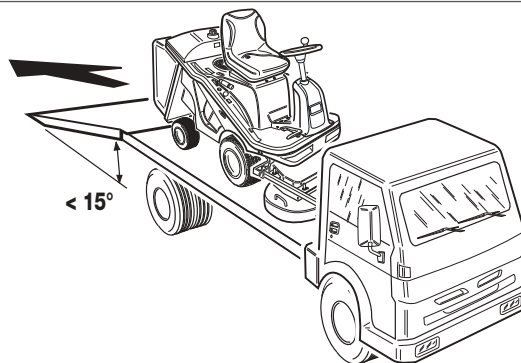

7.

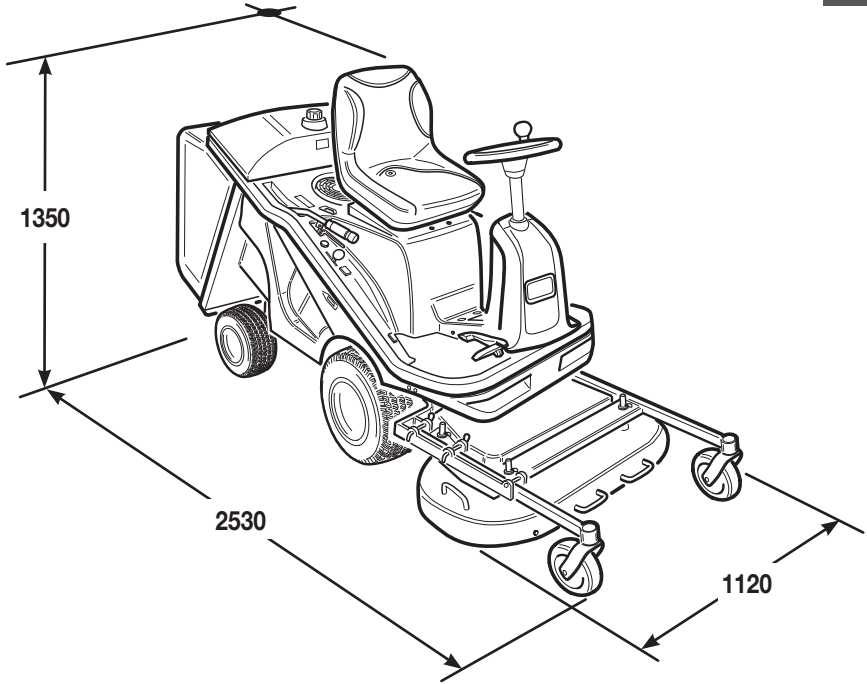

8.

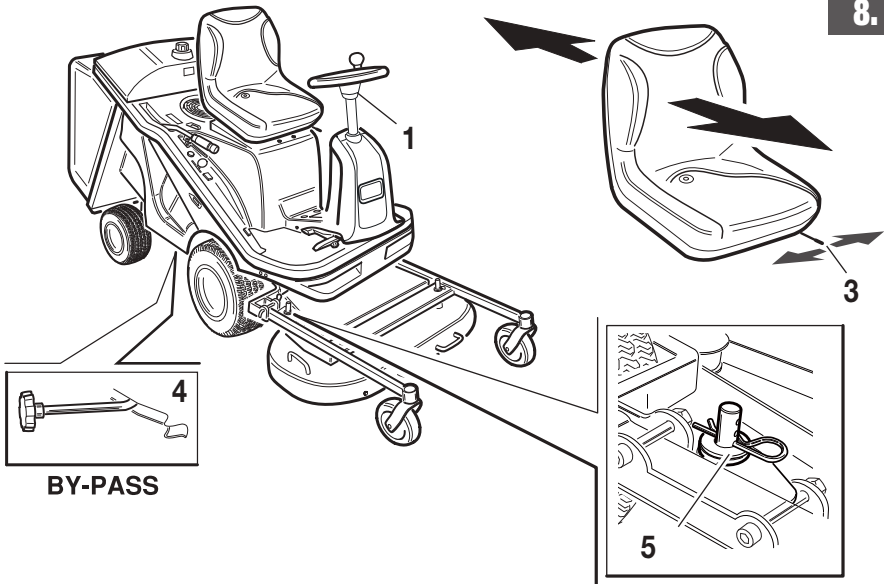

8.

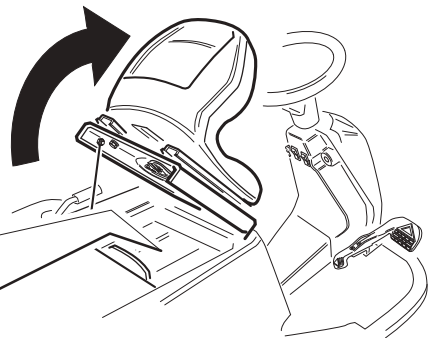
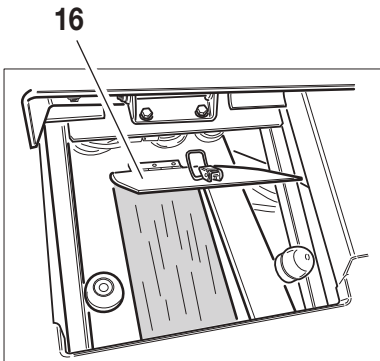
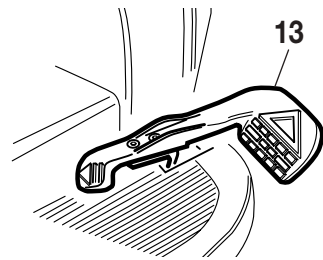
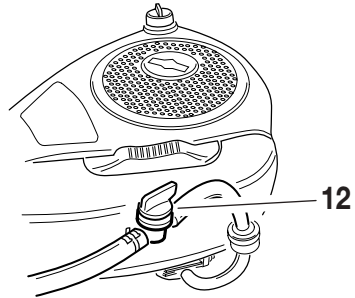
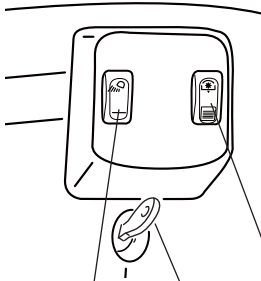
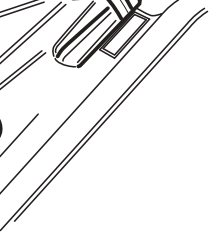
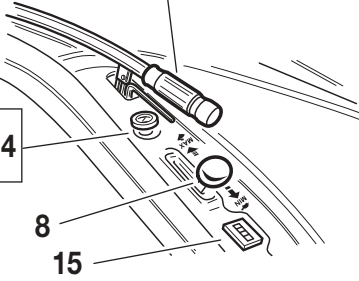

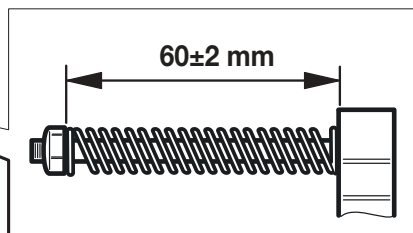
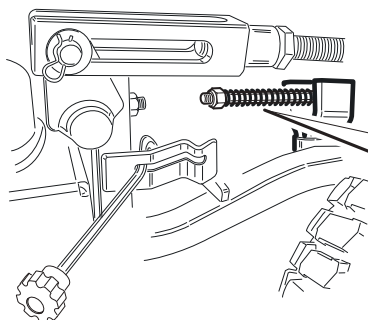
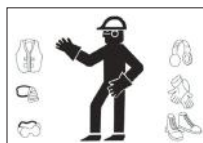
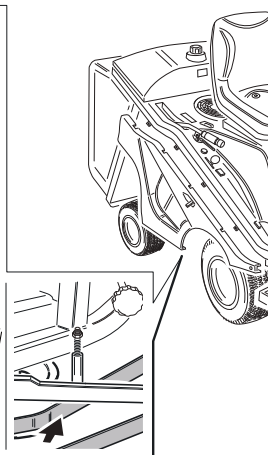
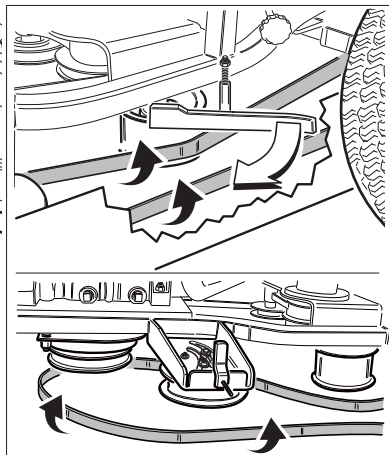
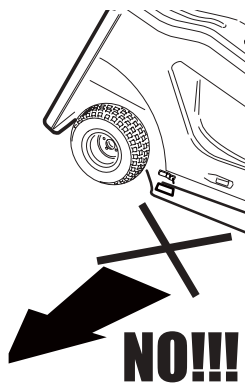
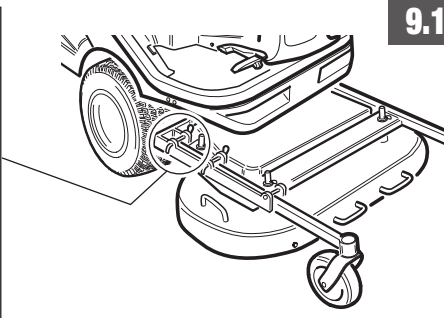
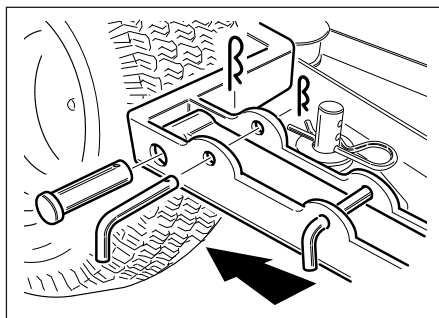

9.2

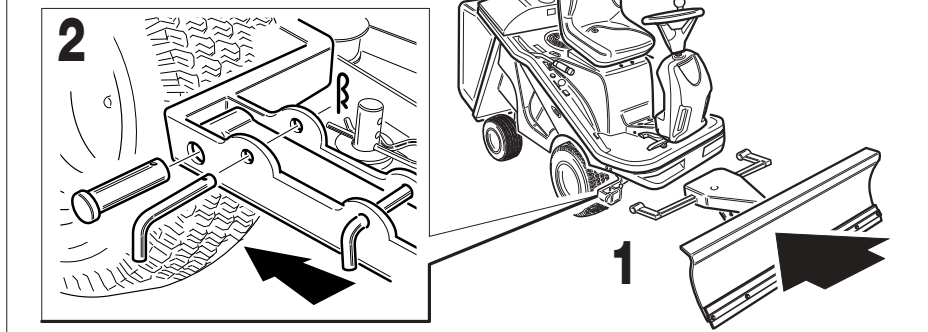

9.3

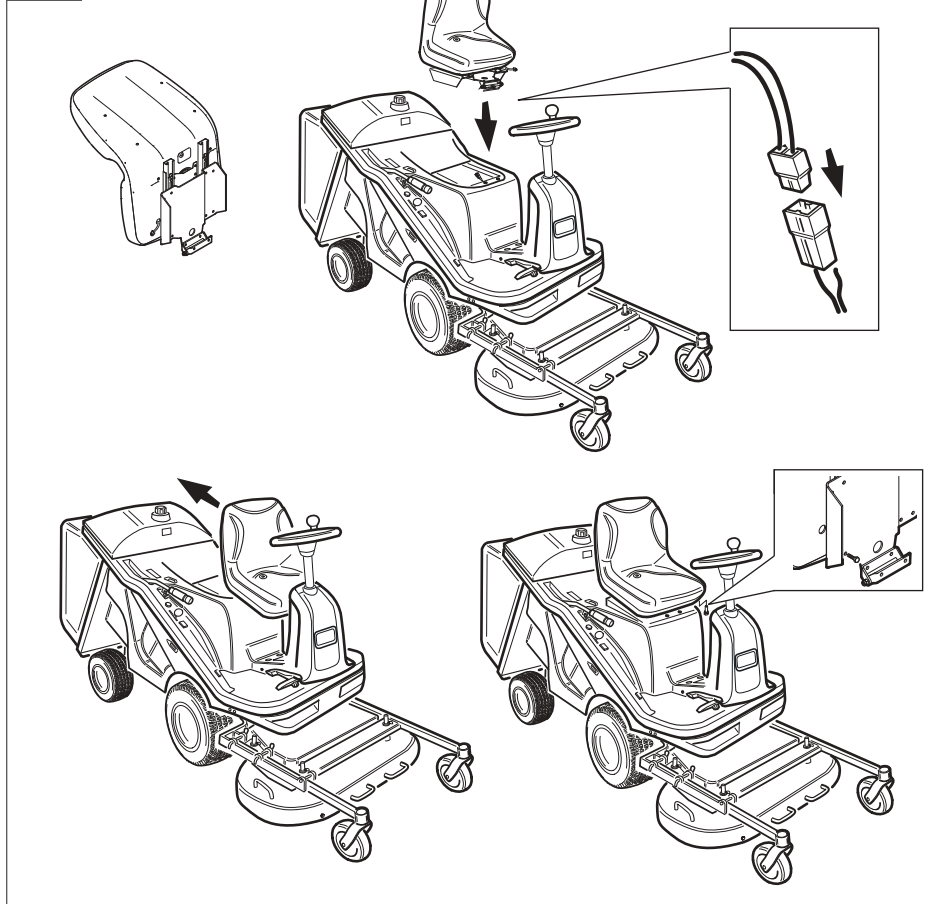

10.1

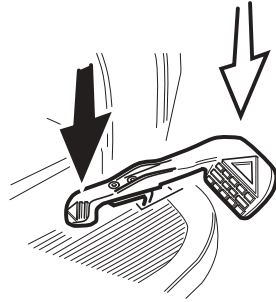
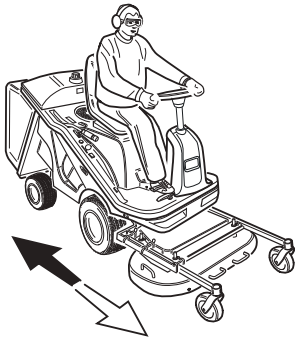

10.2

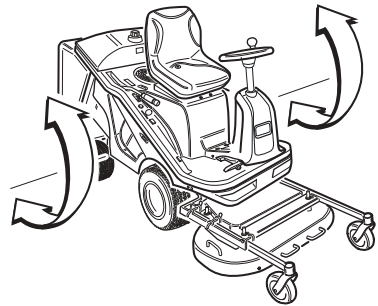
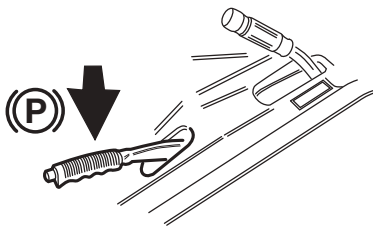
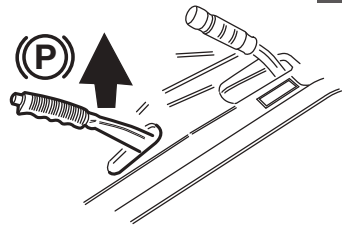
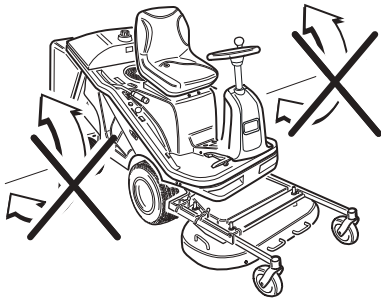

10.3

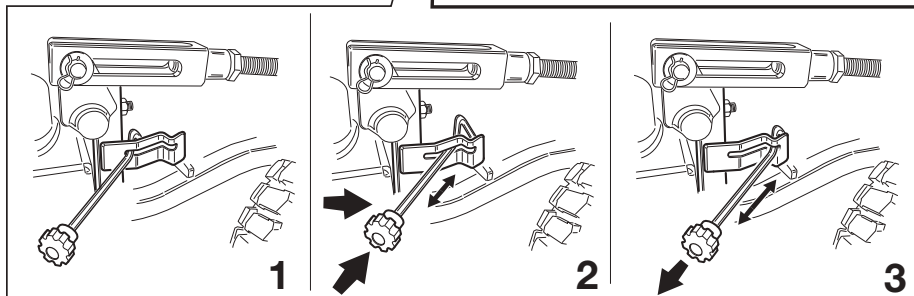
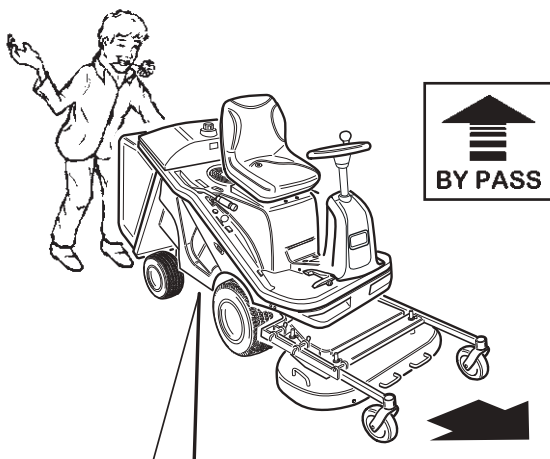
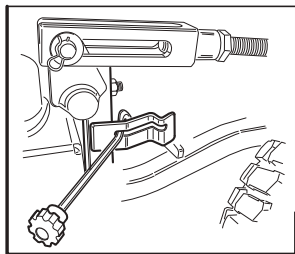

10.4

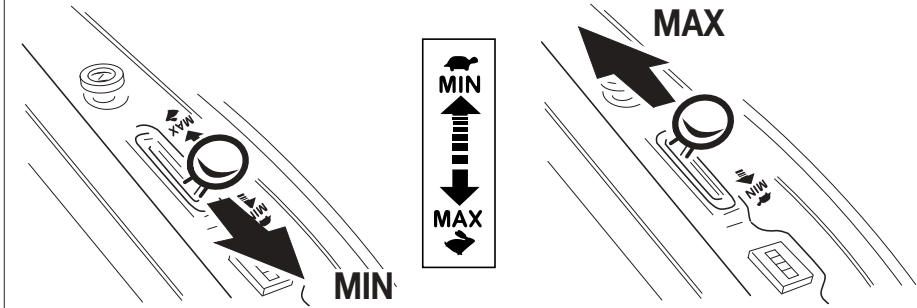

10.5

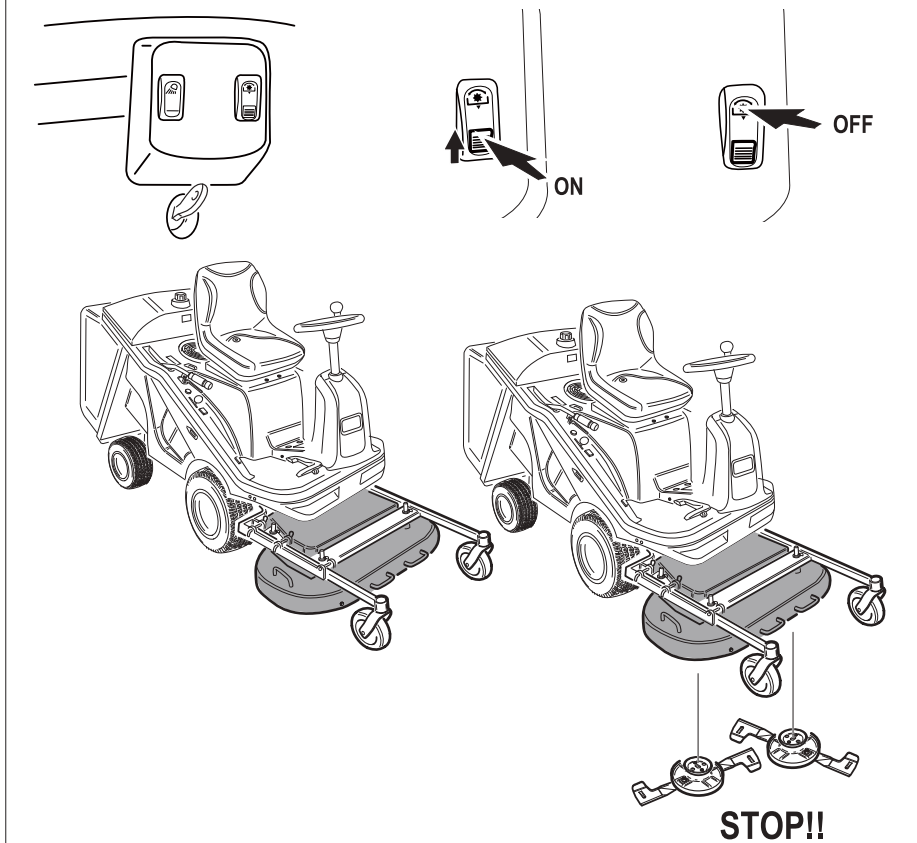

10.6

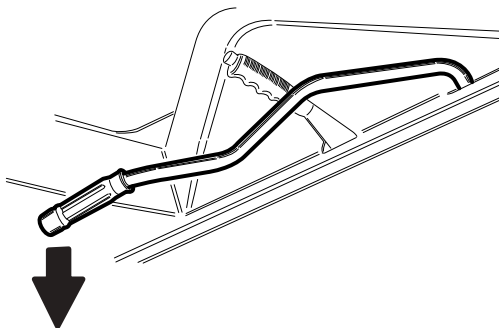
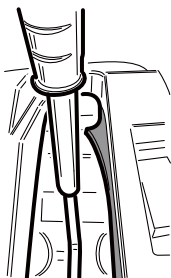
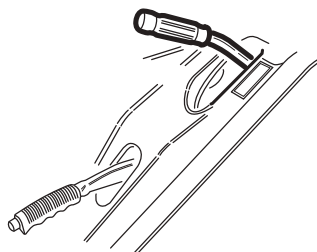
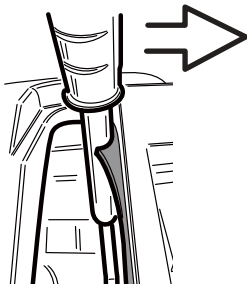
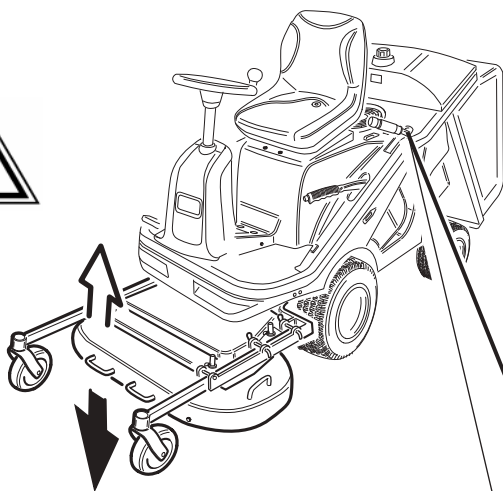

10.7

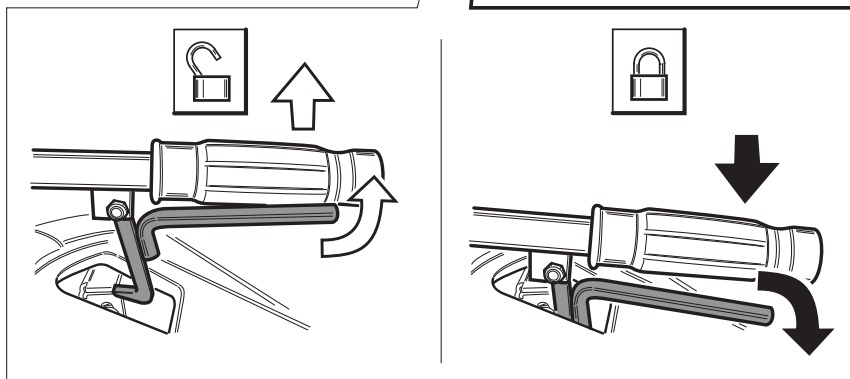

10.8

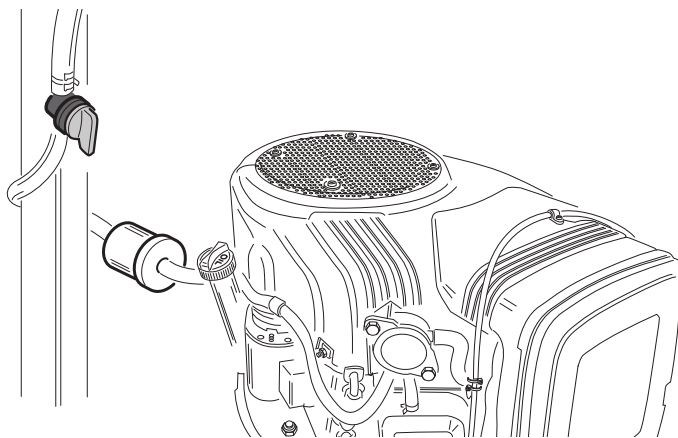

10.9

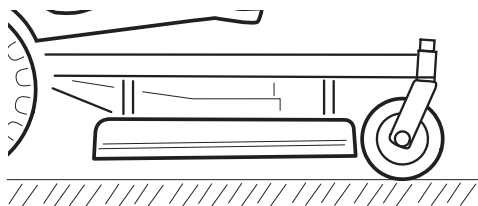
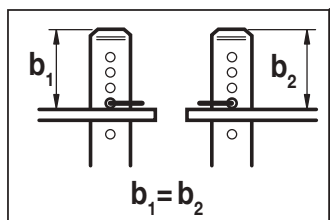
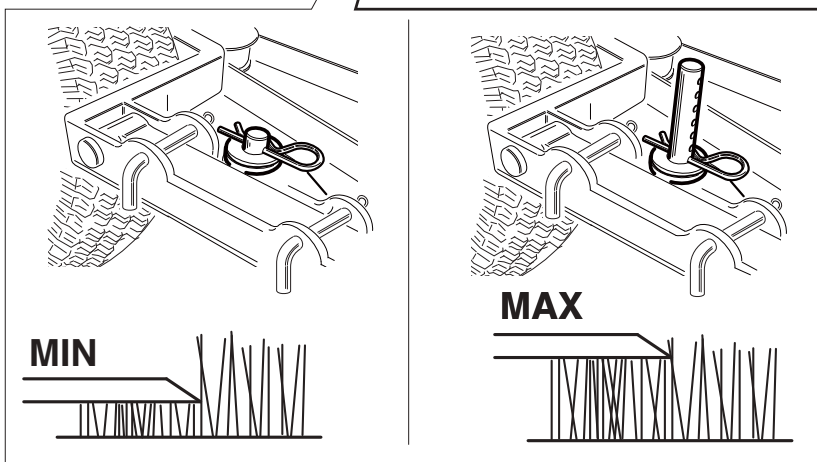
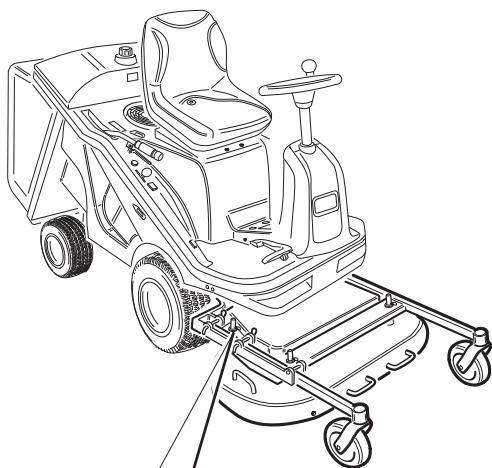

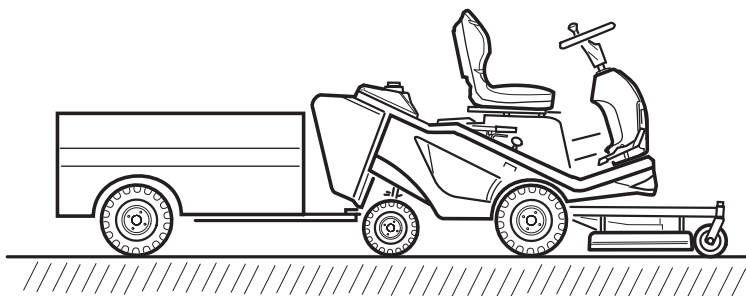

A + B = MAX 140 kg
B ≤ 30 kg

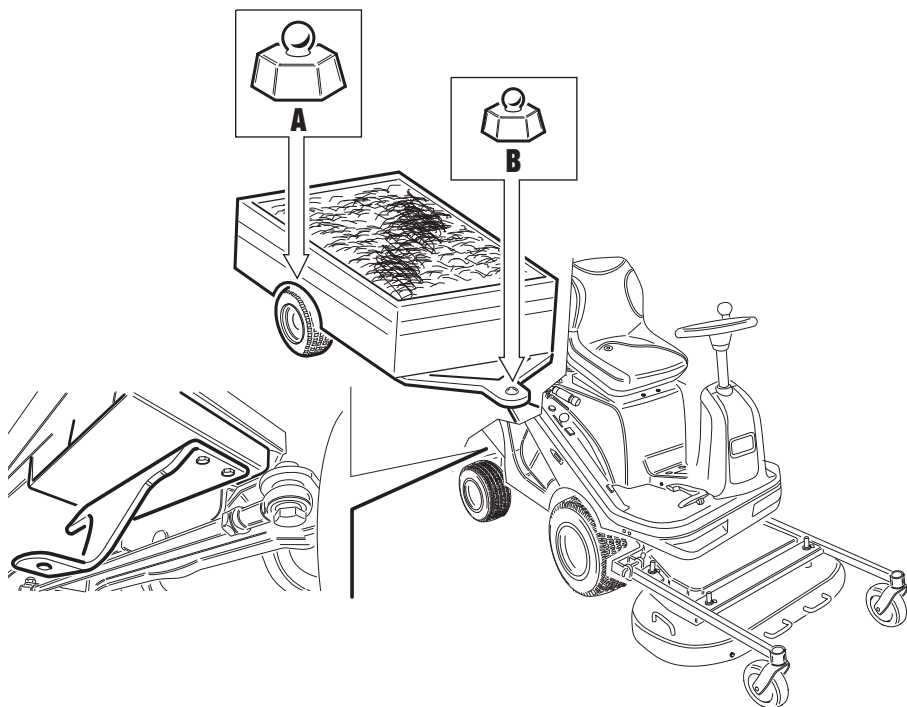

BRIGGS&STRATTON

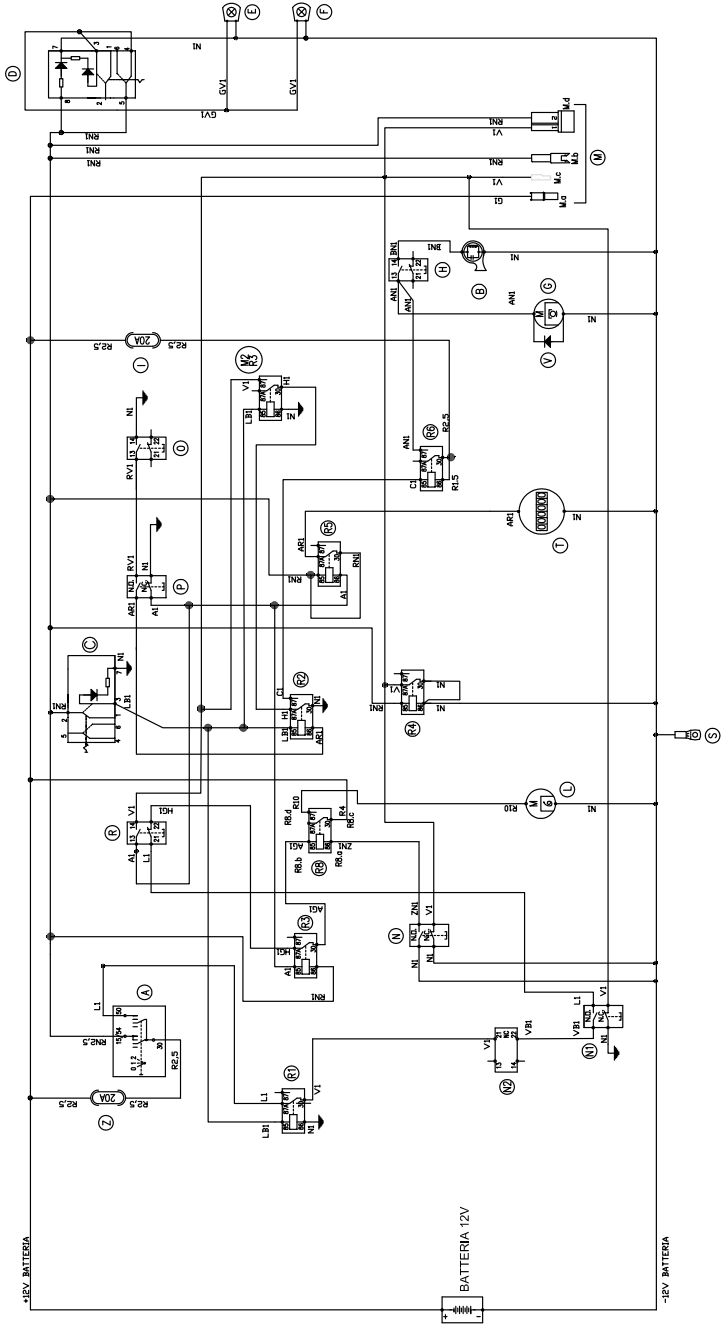

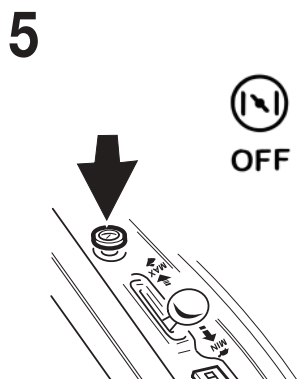
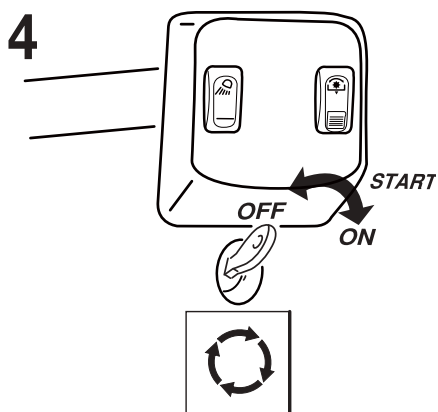
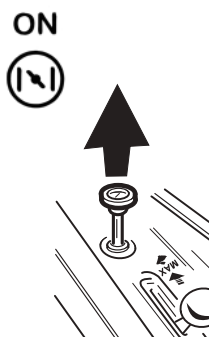
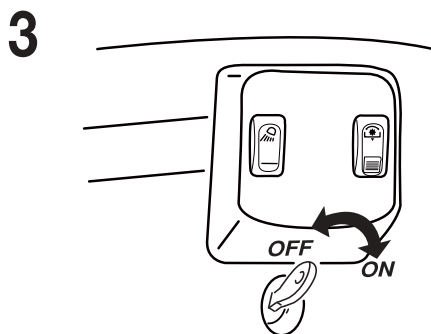
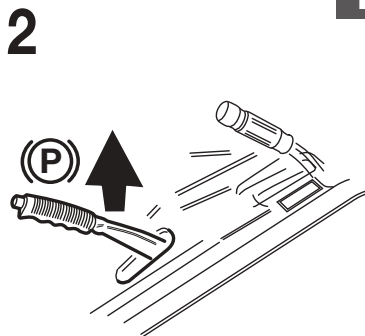

13.

1

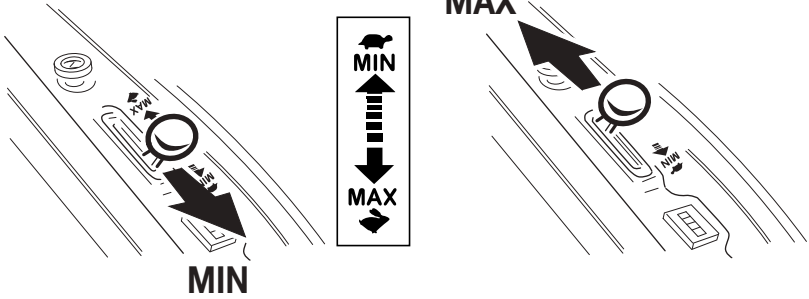

2

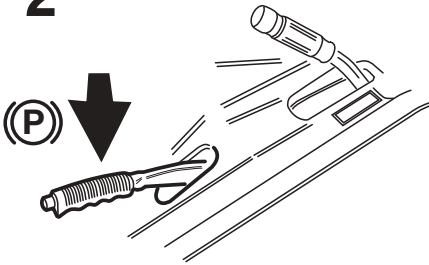

3

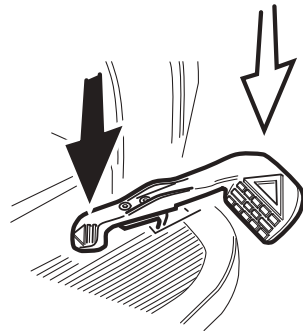

4

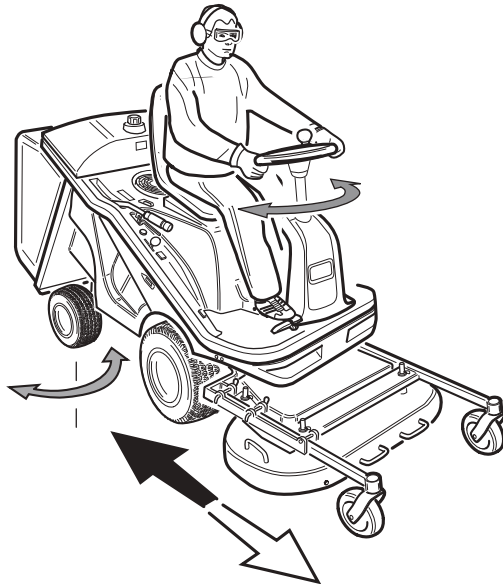

14.

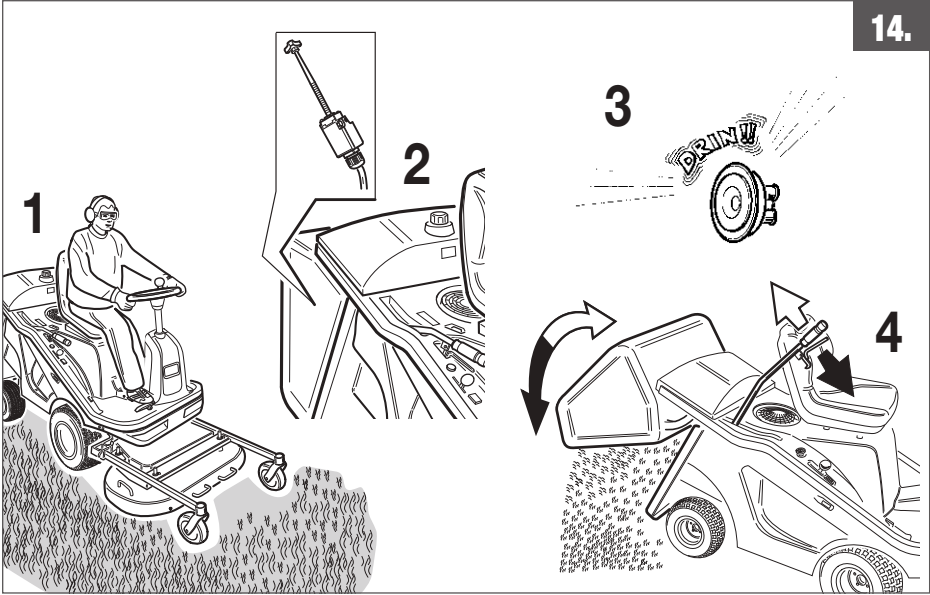

14.1

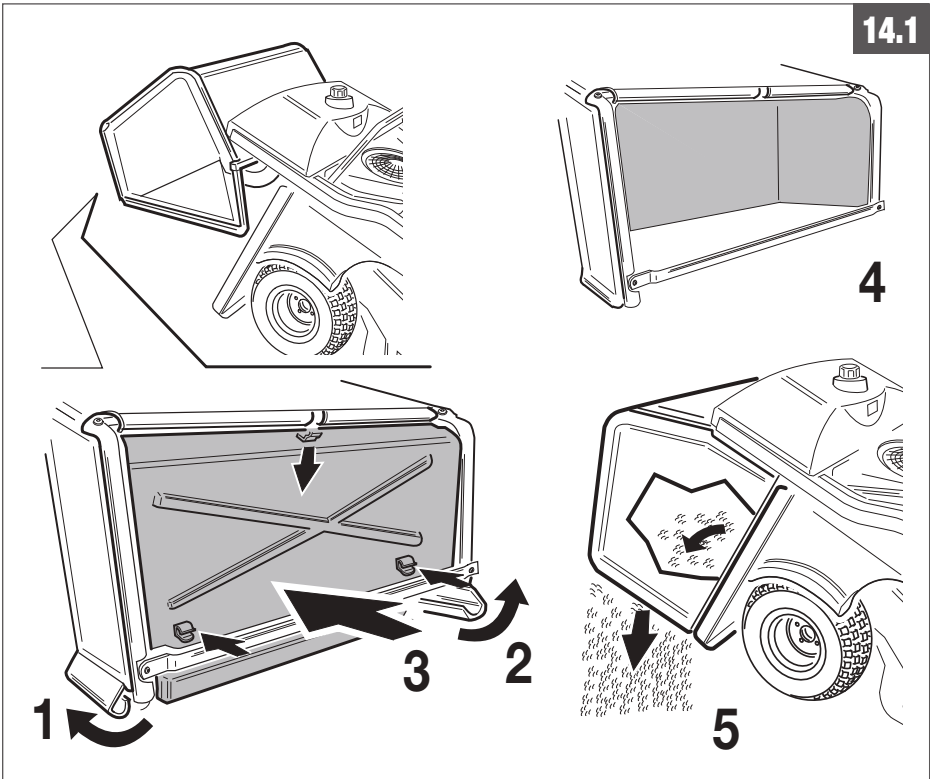

16.

OK

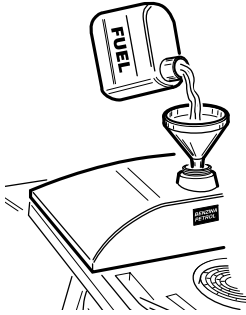

NO !!

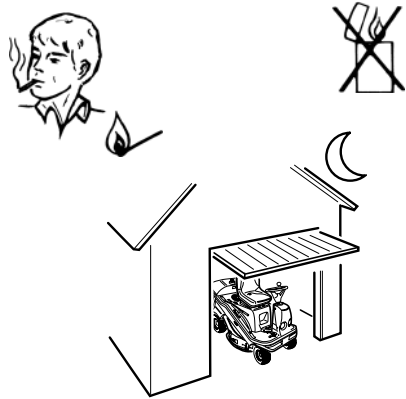

17.1

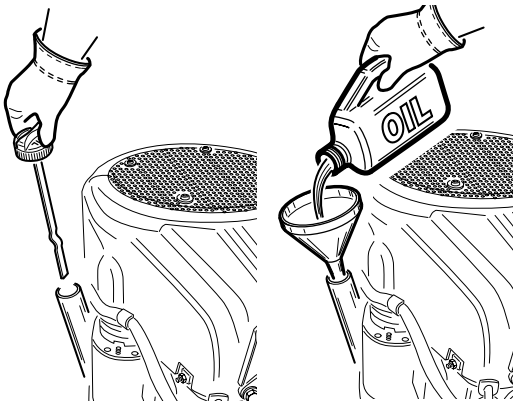

OIL 10W-40

17.2

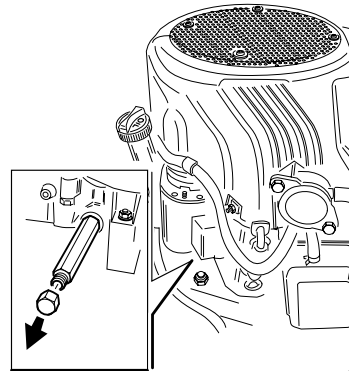

17.3

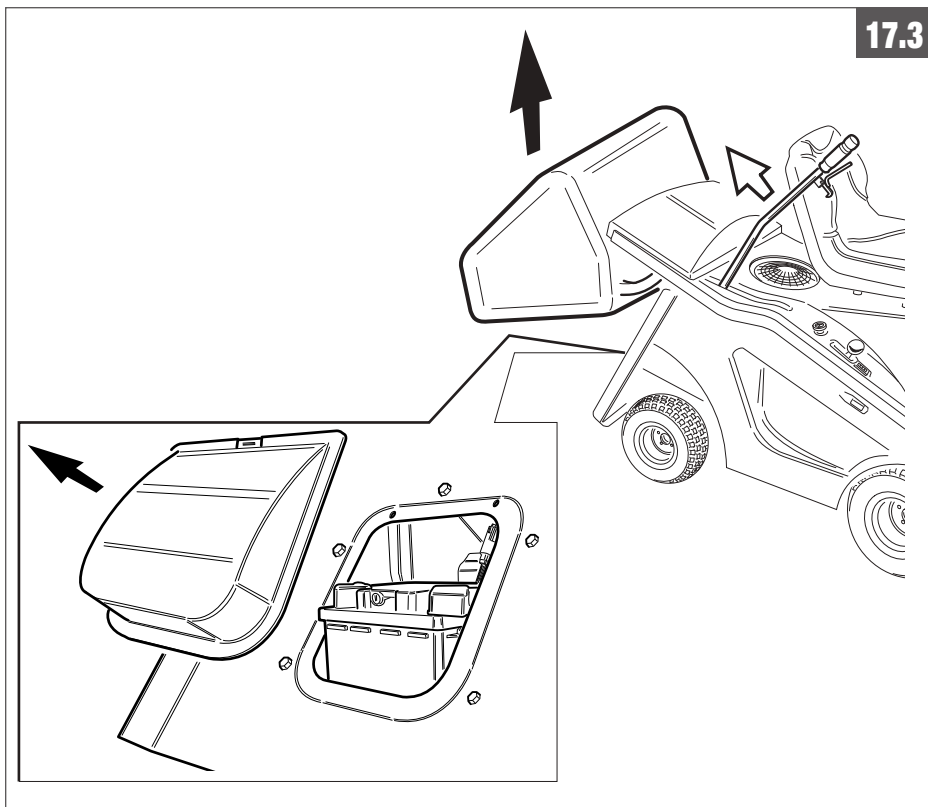

17.4

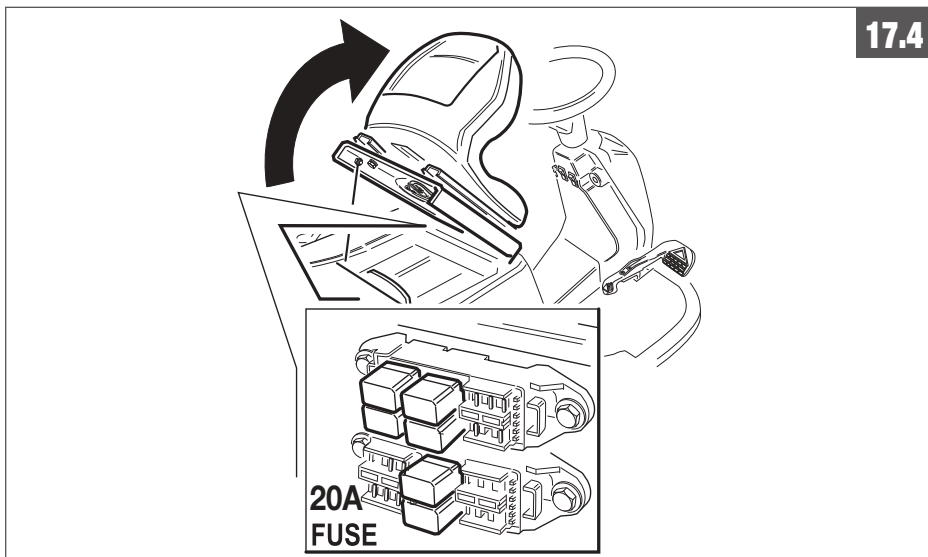

17.5

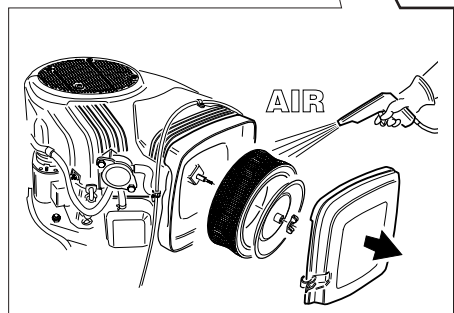
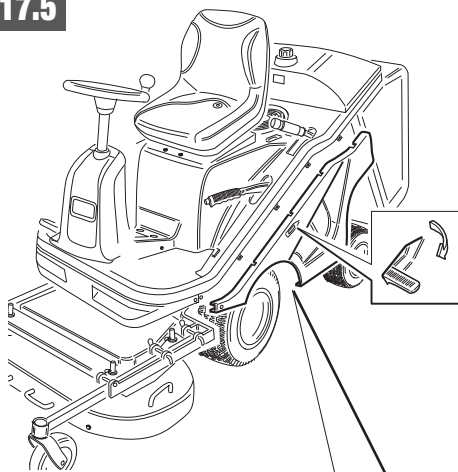

17.6

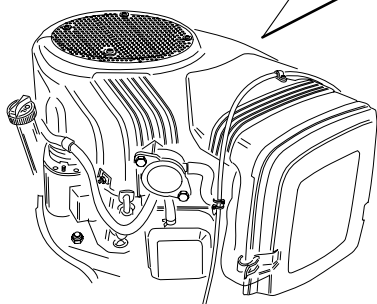
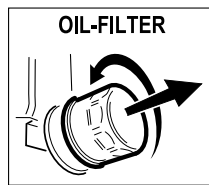

17.7

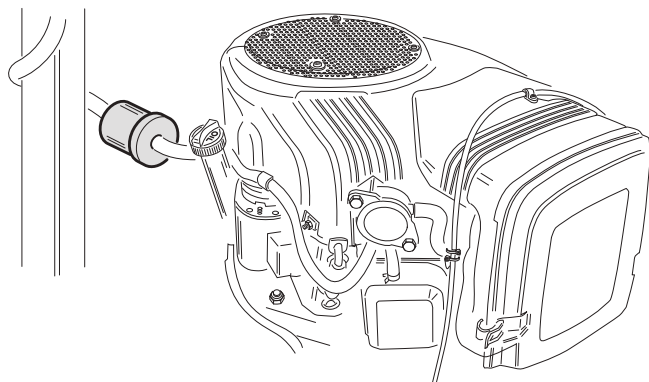

17.8

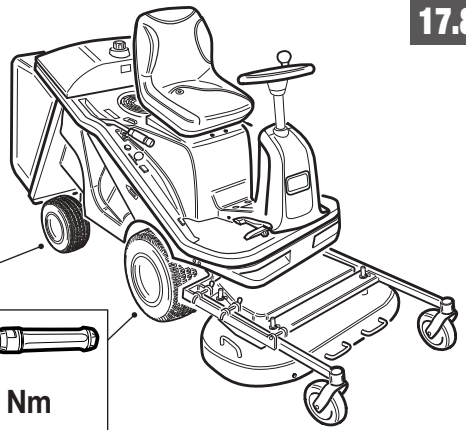

13'' - 1,9 bar

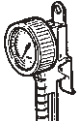

16'' - 1,4 bar



91 ± 2 Nm

17.9

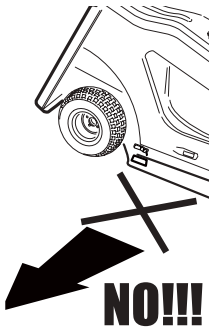

NO!!!

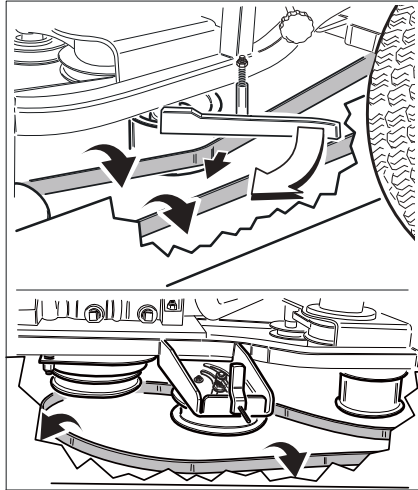

1

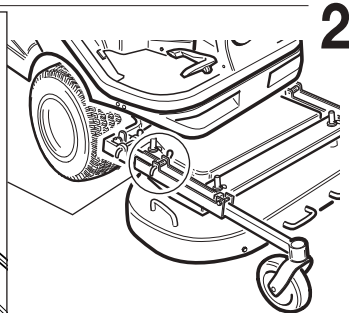
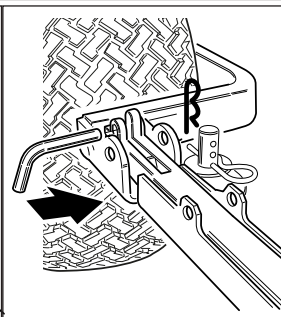
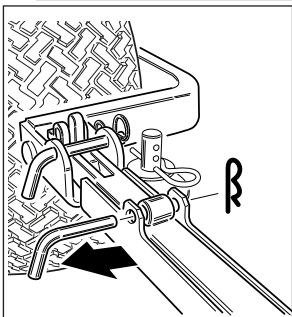
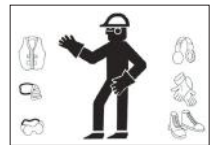
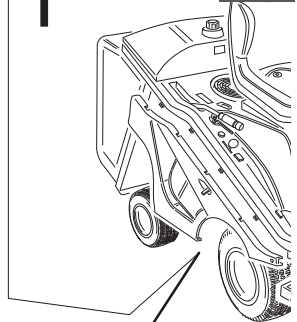

2

17.9

3

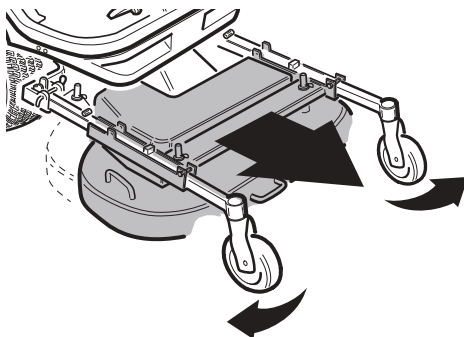

4

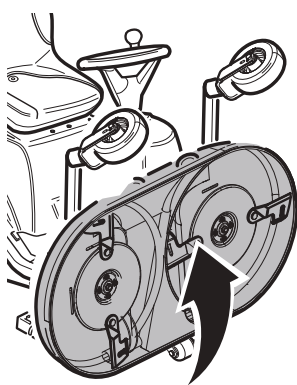

1

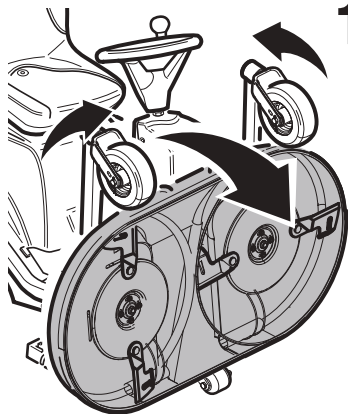

2

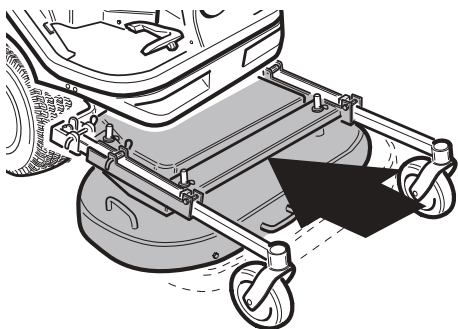

3

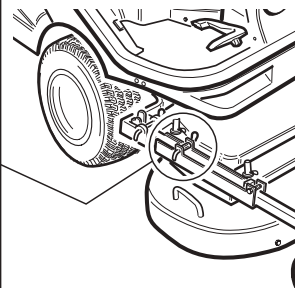
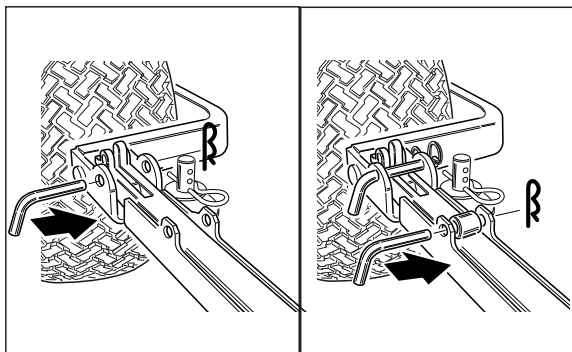

17.9

4

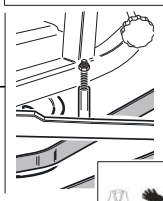
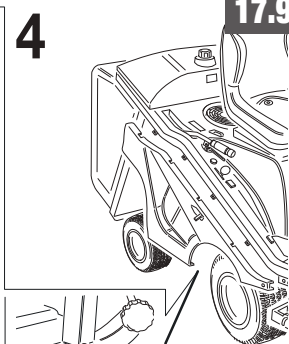
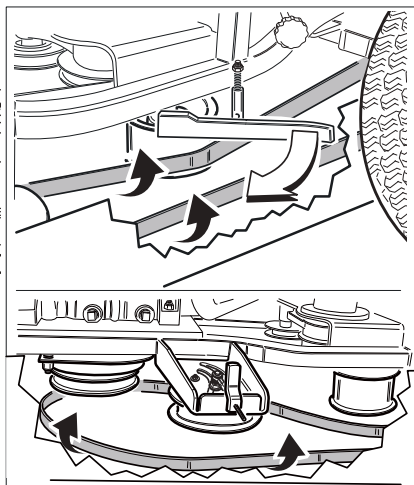
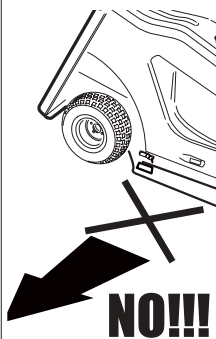

17.10

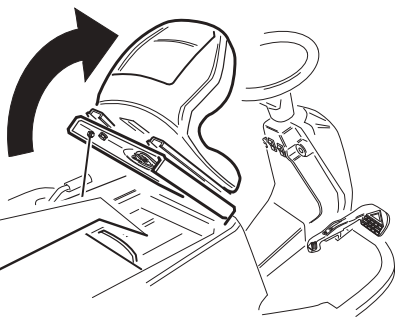
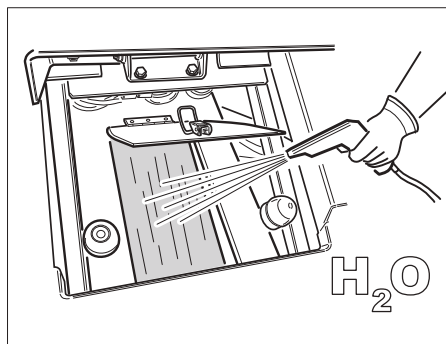
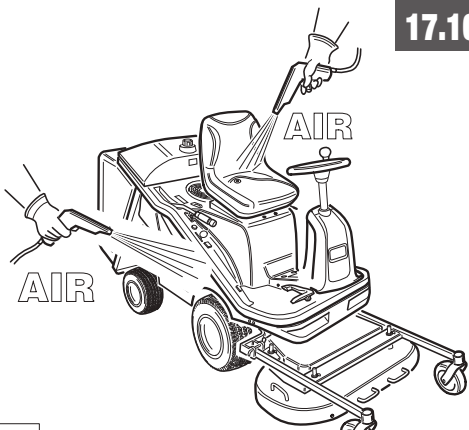
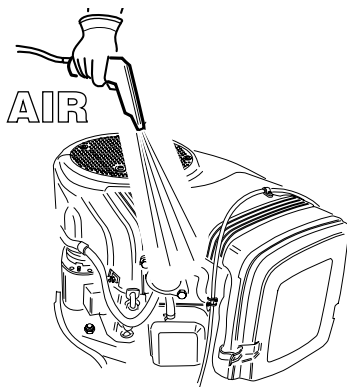

17.10

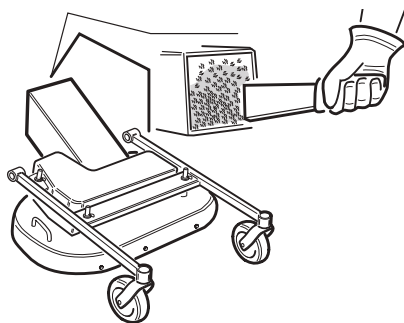
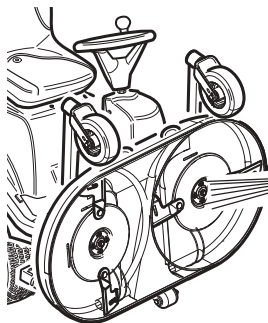

17.11

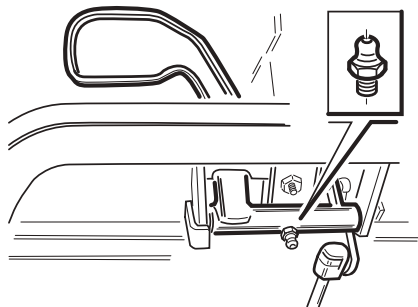
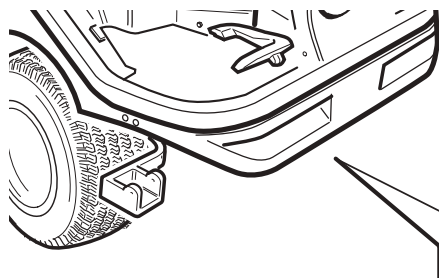
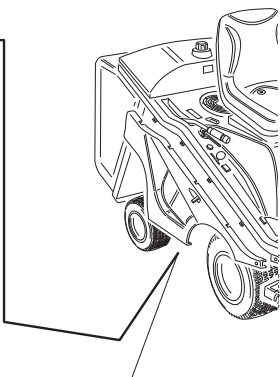
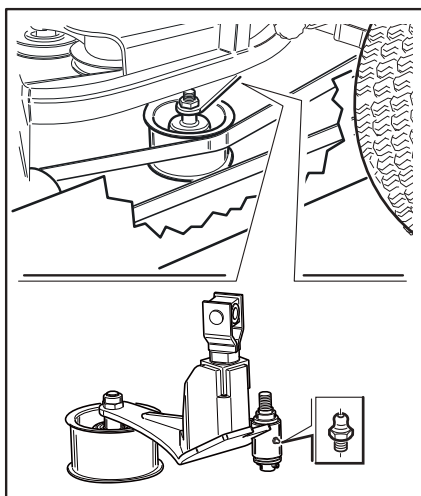
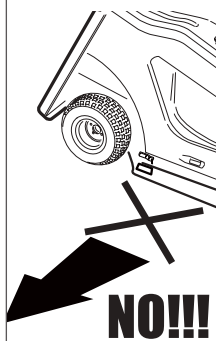

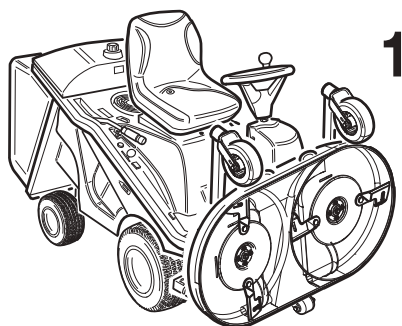

2

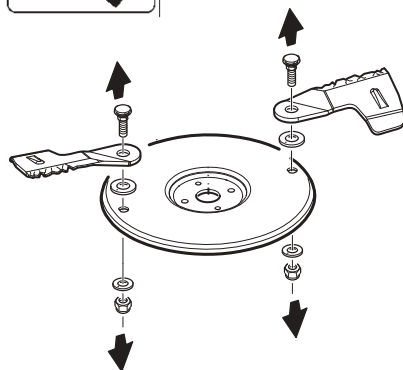
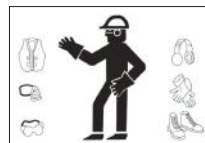
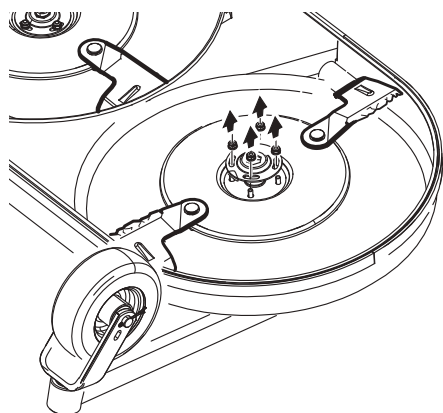

3a

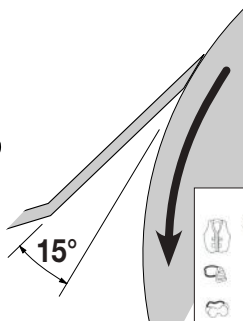
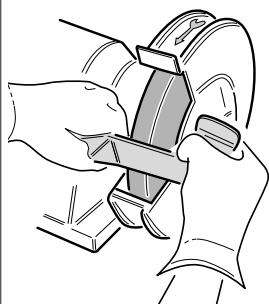

3b

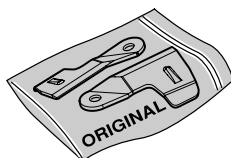

NEW - ORIGINAL

17.12

4

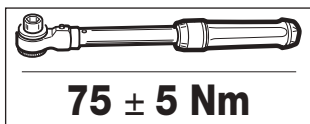
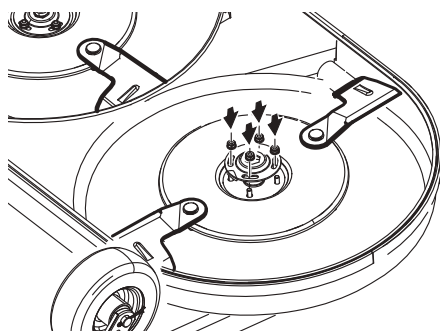
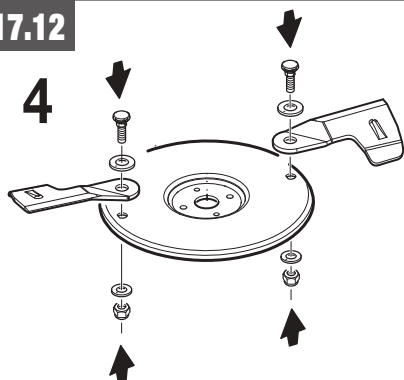

17.13

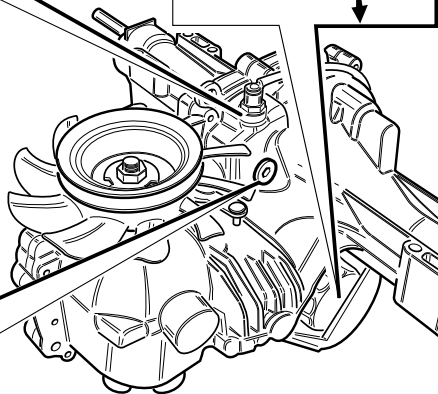
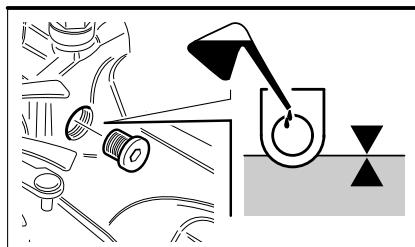
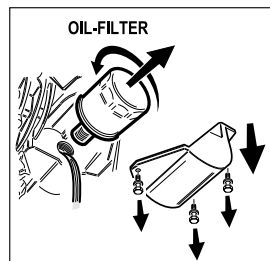

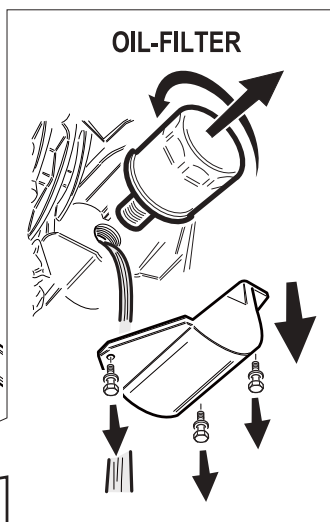
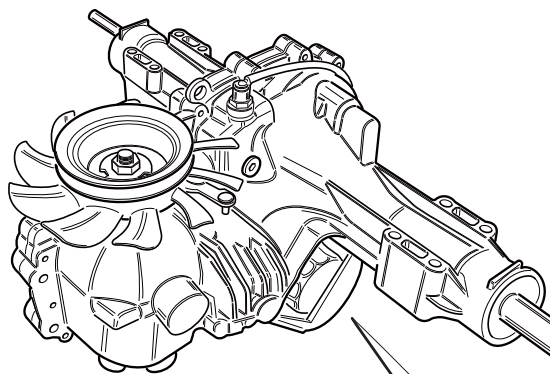

20.

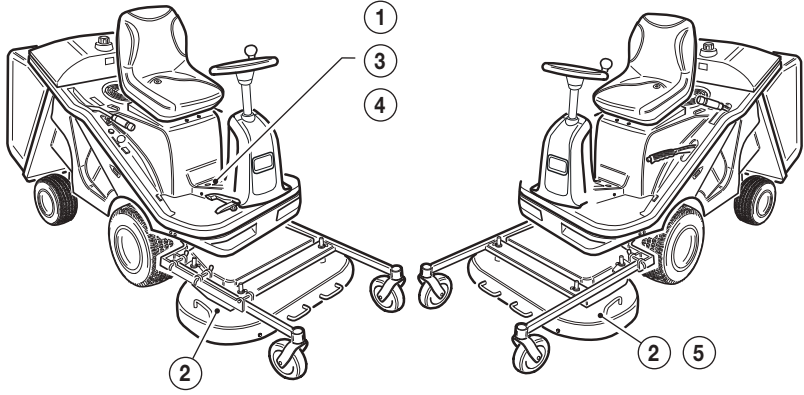

1



2 x2



3





4

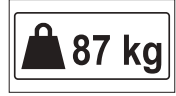

5





	 LWA  dB CE
Type:	
.....-s/n -Art.N	

Manufactured for

GGP ITALY SPA

Via del Lavoro, 6

I-31033 Castelfranco Veneto (TV) ITALY



Manufactured by OFFICINE BIEFFEBI S.p.A., Via dell'Artigianato, 7 46023 Gonzaga (Mantova) Italy

• Soggetto a modifiche senza preavviso • Подлежи на промени без предупредение • Moguće su promjene bez najave • Možnost zmien bez pŕedešlého upozornění • Ret til ændringer forbeholdes • Kann ohne Vorankündigung geändert werden • Υπόκειται σε αλλαγές χωρίς προειδοποίηση • Subject to modifications without notice • Sujeto a modificaciones sin previo aviso • Võimalikud muudatused ilma ette teatamata • Voidaan tehdä muutoksia ilman ennakkoiloitusta • Sujet à des modifications sans aucun préavis • Podložno promjenama bez prethodne obavijesti • Előzetes értesítés nélkül módosítható • Objekto pakeitimai be perspėjimo • Var tikt mainīts bez iepriekšēja brīdinājuma • Подлежи на промени без претходно известување • Kan zonder kennisgeving wijzigingen ondergaan • Kan endres uten forvarsel • Poddawany modyfikacjom bez awizowania • Sujeito a alterações sem aviso prévio • Poate fi modificat, fără preaviz • Может быть изменено без преомления • Možnosť zmien bez pŕedošlého upozornenia • Lahko pride do sprememb brez pŕedhodnega obvestila • Podložno izmenama bez upozorenja • Kan utsättas för modifieringar utan att detta meddelas • Önceden haber verilmeksizin deęiştirilebilir